

No. 6370ZB

Clamping flange, Set

Consisting of two single-clamp buckles, nitrided.

Order no.	Size	Set contents [St]	dia. D	dia. DB	H	dia. LK	M	Weight [g]
426825	K10	2	114	77,5	7,75	94	8,5	360
426833	K20	2	164	110,0	13,00	136	11,0	800
426841	K40	2	202	146,0	16,00	172	13,0	1100

Application:

Clamping flanges are used to fasten surface-mounted clamping modules on the machine table.

On request:

- Special clamping flanges for various T-slot tables
- Clamping flange and housing manufactured as a single piece

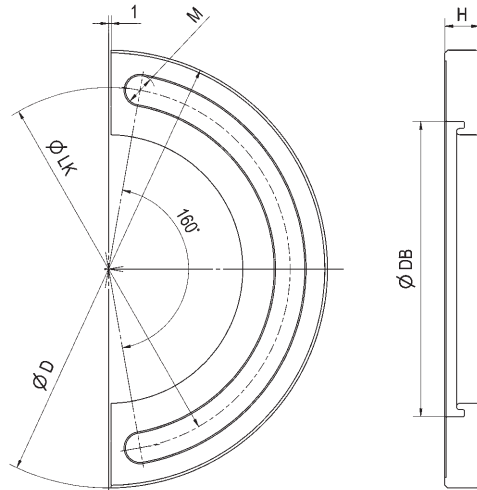

Examples of machine-table mounting:

K10 - Groove distance 50 mm

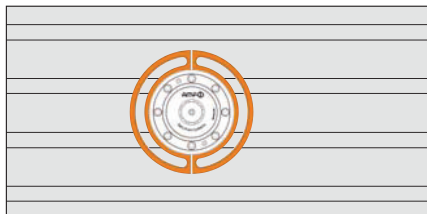

Groove distance 63 mm

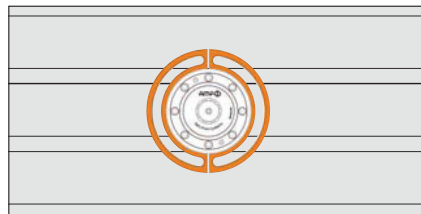

Groove distance 80 mm

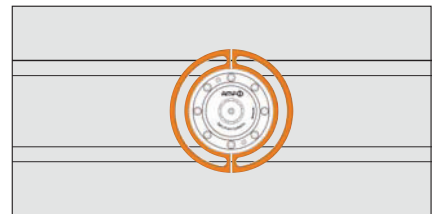

K20 - Groove distance 50 mm

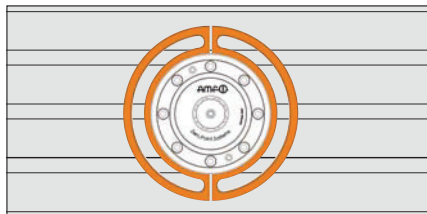

Groove distance 63 mm

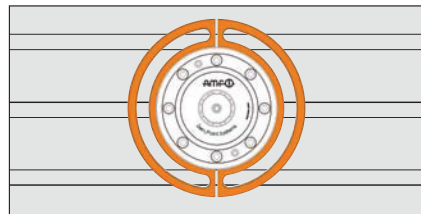

Groove distance 80 mm

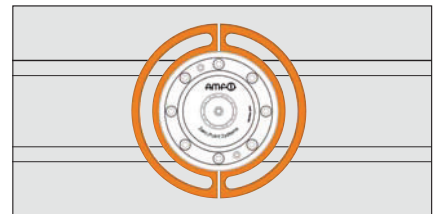

K40 - Groove distance 50 mm

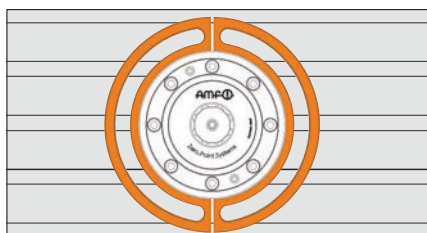

Groove distance 63 mm

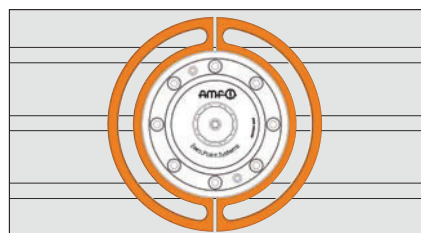

Groove distance 80 mm

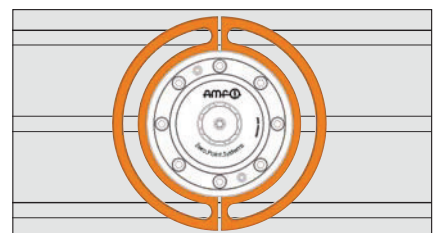

Subject to technical alterations.