

Floor Standing Enclosures
Aluminium Range | Aluminium
Double wall, compact | EKOM

IP 66 | TYPE 4X, 12, 13 | IK 10



01

Floor Standing Enclosures

1

Material:

Aluminium AlMg3. Frame: 2 mm. Door: 2 mm. Rear panel: 2 mm. Rain hood: 2 mm. Double wall: 2 mm.

Body:

One piece enclosure body. Integrated depth profiles with hole pattern allowing mounting plate to be adjusted in depth. The frame in multiple door versions, is divided into individual modules by means of vertical dividers.

Door:

Double walled with top and bottom ventilation openings allowing air flow. Mounted with concealed hinges allowing left or right hand opening. Multiple door version has individual lockable doors.

Rear panel:

Fastened from the inside. Standard facilities for rear door mounting.

Double wall:

Rear and lateral double walls with top and bottom ventilation openings allowing air flow.

Rainhood:

Sloped rainhood with integrated rain gutter and ventilation channels in the perimeter.

Lock:

Espagnolette multiple point locking system. Standard swing handle with security lock.

Bottom plates:

Supplied as accessory.

Earthing:

All panels are earthed through their fittings and are equipped with a separate earthing stud.

Finish:

RAL 7035 structure powder coating 100% polyester.

Protection:

Corresponds with IP 66 | TYPE 4X, 12, 13 | IK 10, when a bottom plate is fitted.

Approvals:

CE, EAC, GOST, cULus_listed. Climatic and Chemically active substances resistance according to EN61969-3 "Mechanical structures for electronic equipment. Outdoor enclosures".

Delivery:

Frame with fitted door with swinghandle, rear panel, rain hood and double walls. Delivery also includes earthing bolts. Delivered on a pallet which is identical to the width of the enclosure to allow suiting without removal. All packing material is recyclable. Mounting plate and bottom plates are not included in the standard delivery.



Dimensional table | EKOM

IP 66 | TYPE 4X, 12, 13 | IK 10

Enclosure dimensions			N° of doors	Item no.
H	W	D		
1200	600	600	1	EKOM12066
1200	800	600	1	EKOM12086
1400	600	600	1	EKOM14066
1400	800	600	1	EKOM14086
1200	1200	600	2	EKOM12126
1400	1800	500	3	EKOM14185



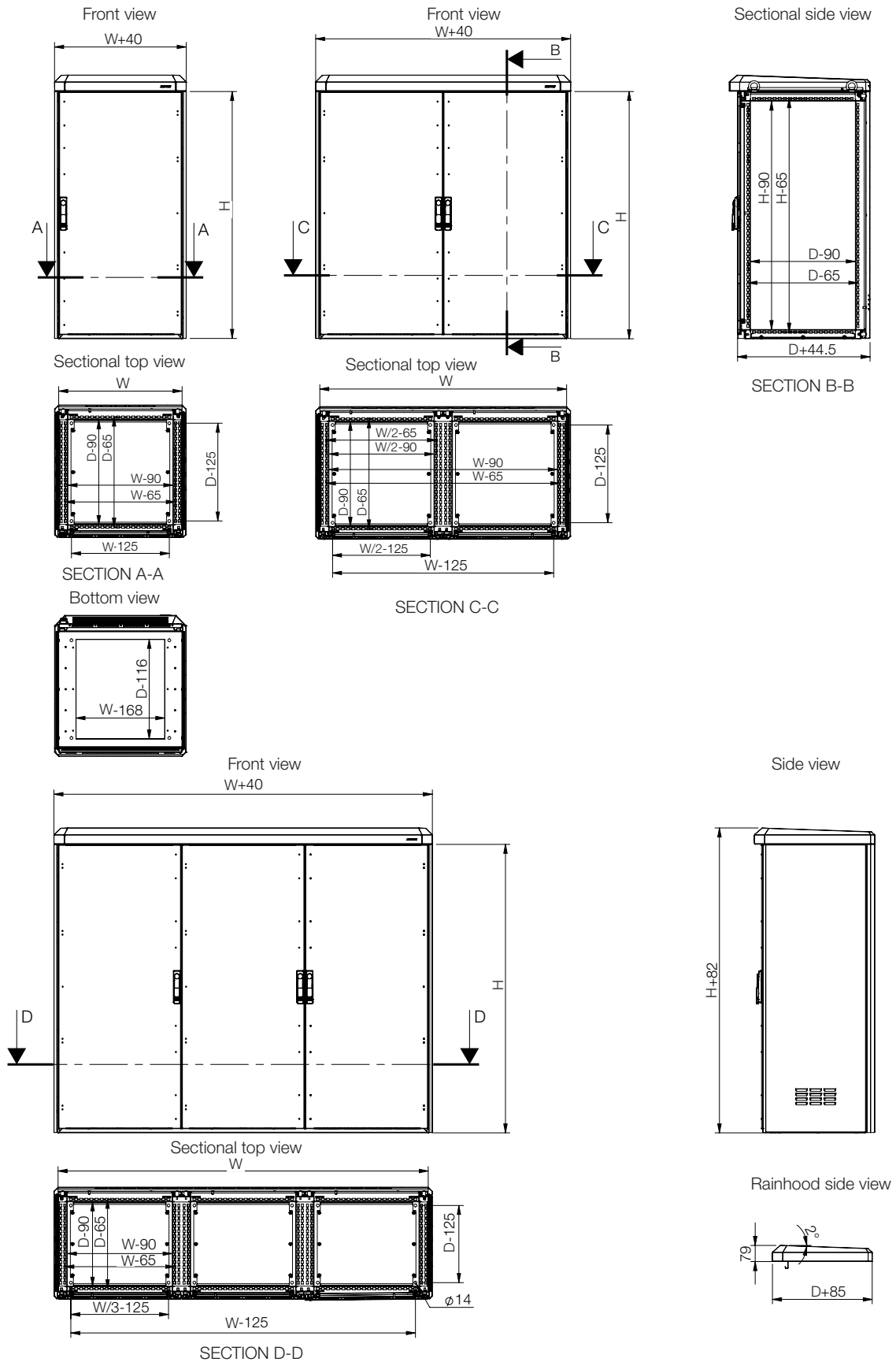

Accessories selection matrix | EKOM

Enclosure				Mounting						
H	W	D	Mounting plate	Aluminium mounting plate	Mounting profile, in H	Mounting profile, in W	Mounting profile, in D	Click in profile, in W	Click in profile, in D	
EKOM12066	1200	600	600	MP1206	MPAL1206	CLPF1200	CLPF600	CLPF600	CLPK600	CLPK600
EKOM12086	1200	800	600	MP1208	MPAL1208	CLPF1200	CLPF600	CLPF600	CLPK800	CLPK600
EKOM14066	1400	600	600	MP1406	MPAL1406	CLPF1400	CLPF600	CLPF600	CLPK600	CLPK600
EKOM14086	1400	800	600	MP1408	MPAL1408	CLPF1400	CLPF800	CLPF600	CLPK800	CLPK600
EKOM12126	1200	1200	600	2x MP1206	2x MPAL1206	CLPF1200	2x CLPF600	2x CLPF600	2x CLPK600	2x CLPK600
EKOM14185	1400	1800	500	3x MP1406	3x MPAL1406	CLPF1400	3x CLPF600	CLPF500	3x CLPK600	CLPK500

Enclosure				Mounting				Fixing	Cable
H	W	D	Mounting profiles (19") *	Brackets for fixing 19" mounting profiles	Carrier bars, in D	Carrier bars, in W	Plinth (100 mm height)	Aluminium bottom plates	
EKOM12066	1200	600	600	CIP24	CIB600	CB600	CB600	PFAL1066	CBPA066
EKOM12086	1200	800	600	CIP24	CIB800	CB600	CB600	PFAL1086	CBPA086
EKOM14066	1400	600	600	CIP29	CIB600	CB600	CB600	PFAL1066	CBPA066
EKOM14086	1400	800	600	CIP29	CIB800	CB600	CB600	PFAL1086	CBPA086
EKOM12126	1200	1200	600	CIP24	CIB600	CB600	CB600	PFAL1126	2x CBPA066
EKOM14185	1400	1800	500	CIP29	CIB600	CB500	CB600	PFAL1185	3x CBPA065

* CIB, CID or CIWR are required.

Mounting plates aluminium, MPAL

Description: Aluminium mounting plate. Fixing bracket kit MPA06 to be ordered separately. For heavy loads in vibrating environments use mounting plate reinforcement profile MPR and MPE or MPEF brackets.

Material: 3 mm Aluminium Al Mg3.

Pack quantity: 1 piece.

For enclosure		Mounting plate dimensions		Item no.
H	W	h	w	
1200	600	1094	494	MPAL1206
1200	800	1094	694	MPAL1208
1400	600	1294	494	MPAL1406
1400	800	1294	694	MPAL1408



Aluminium plinth, PFAL

Description: Aluminium plinth allows cabling without any restrictions. The plinth consists of two lateral profiles with removable front and rear plates.

Material: Aluminium AlMg3. Profiles: 3 mm and panels 2 mm.

Finish: RAL 7035 polyester powder coated.

Pack quantity: 1 plinth with mounting material.

For enclosure			Item no.
H	W	D	
100	600	400	PFAL1064
100	600	600	PFAL1066
100	800	400	PFAL1084
100	800	600	PFAL1086
100	1200	400	PFAL1124
100	1200	600	PFAL1126
100	1800	400	PFAL1184
100	1800	500	PFAL1185

Note: Plinth 1800 mm wide made of two pieces.



Floor Standing Aluminium Range Accessories

Ground mounted plinth, PGM

- Description:** Ground mounted plinth 1000 mm height.
Excavation depth: 700-950 mm.
- Material:** 2 mm galvanized steel.
- Finish:** RAL 7035 polyester powder coated.
- Pack quantity:** 1 kit of ground mounted plinth.

For enclosure			
H	W	D	Item no.
1000	600	400	PGM10064
1000	600	600	PGM10066
1000	800	400	PGM10084
1000	800	600	PGM10086
1000	1200	400	PGM10124
1000	1200	600	PGM10126
1000	1800	400	PGM10184



Side panels aluminium, SPMA

- Description:** Easy one man assembly. Sealed by an extruded, one piece polyurethane gasket and mounted with screws.
- Material:** Aluminium ALMg3.
- Finish:** RAL 7035 structured powder coating 100% polyester.
- Protection:** IP 66 | TYPE 4X, 12, 13.
- Pack quantity:** 2 double wall side panels with mounting accessories.

For enclosure		
H	D	Item no.
1600	600	SPMA1606
1800	600	SPMA1806
2000	600	SPMA2006

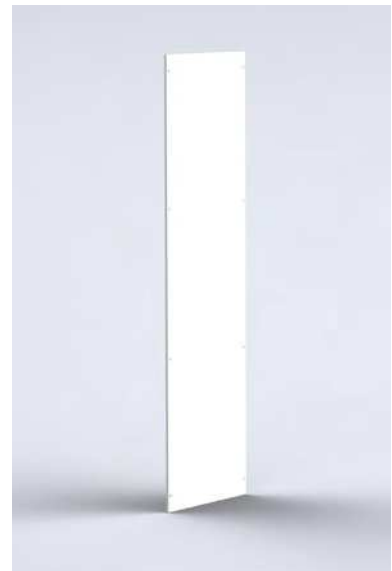

Aluminium bottom plates, CBPA

Description: One piece bottom plate. To achieve perfect sealing use the gasket kit BG01.

Material: 2 mm Aluminium AIMg3.

Finish: RAL 7035 polyester powder coated.

Pack quantity: 1 kit of bottom plate.

For enclosure		
W	D	Item no.
600	400	CBPA064
600	500	CBPA065
600	600	CBPA066
800	400	CBPA084
800	600	CBPA086

Note: For enclosures 1200 mm & 1800 mm wide use 2 x 600 mm or 3 x 600 mm wide bottom plates.

