

## CLAMPING CLAW, INFINITELY VARIABLE

2140.13.

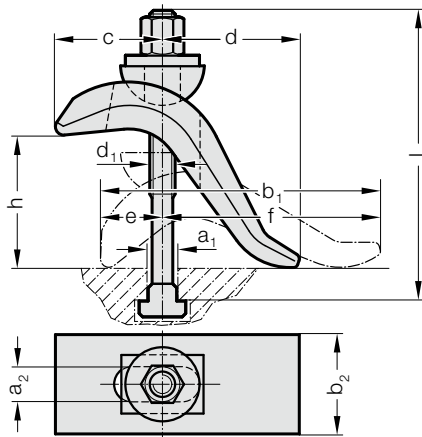

2140.13. Clamping claw, infinitely variable

Order No	a <sub>1</sub>	a <sub>2</sub>	b <sub>1</sub>	b <sub>2</sub>	c	d	e	f	h*	Clamping bolt
										d <sub>1</sub> x a <sub>1</sub> x l
2140.13.12.17	12	17	140	50	55	60	30	110	0-50	M12x12x125
2140.13.14.17	14	17	140	50	55	60	30	110	0-50	M12x14x125
2140.13.16.17	16	17	140	50	55	60	30	110	0-75	M16x16x160
2140.13.18.17	18	17	140	50	55	60	30	110	0-75	M16x18x160
2140.13.16.21	16	21	175	60	70	80	40	135	0-65	M16x16x160
2140.13.18.21	18	21	175	60	70	80	40	135	0-65	M16x18x160
2140.13.22.21	22	21	175	60	70	80	40	135	0-85	M20x22x200

\*Clamping height

**Material:**

Steel, forged and head-treated, tempered in burnishing clay.

**Note:**

Clamping claws quickly span very different clamping heights without the need for additional supports and take up very little space on the machine table. They are designed for maximum loads and are particularly suitable for clamping cutting and punching tools.

Supplied with clamping bolt, suitable clamping bolts: 2140.30.

2140.14.

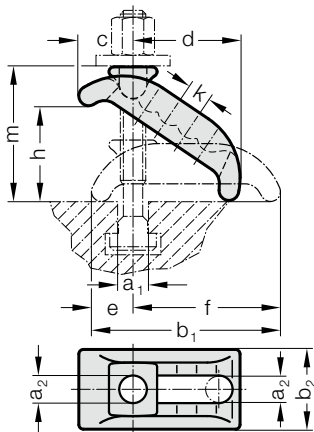

2140.14. Clamping claw, infinitely variable

Order No	a <sub>1</sub>	a <sub>2</sub>	b <sub>1</sub>	b <sub>2</sub>	c	d	e	f	k	m	h <sub>max</sub>
2140.14.13	14	13	88	38	28	48	23	68	14	52	35
2140.14.18	18	18	130	56	38	74	29	101	18	80	55
2140.14.22	22	22	140	66	46	80	32	112	20	98	65
2140.14.26	28	26	174	76	52	100	39	135	24	110	75
2140.14.32	36	32	200	90	61	110	44	156	28	118	80

**Material:**

Steel, forged and heat-treated, galvanised and yellow passivated

**Note:**

Clamping claws quickly span very different clamping heights without the need for additional supports and take up very little space on the machine table. They are designed for maximum loads and are particularly suitable for clamping cutting and punching tools.

Supplied without clamping bolt, suitable clamping bolts: 2140.30.