

滚珠导轨

2198.42.

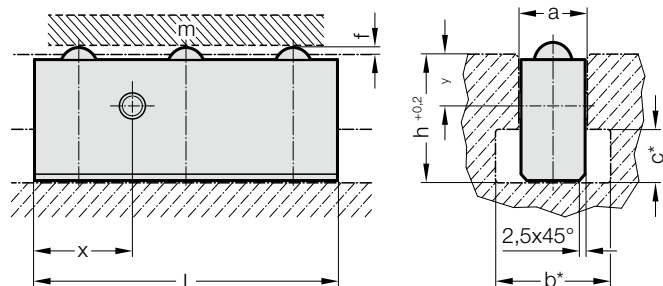

说明:

将滚珠导套插入压力机工作台的 T 型槽 DIN 650 中并使用夹紧件固定。根据 T 型槽的大小和所需承载力来确定滚珠导套的大小和使用数量。将工具卡紧并放置在压力机工作台上, 这时夹紧压力会将滚珠压入凹槽内。

* T 型槽并非绝对必要

2198.42. 滚珠导轨

| 订购编号 | a | 起重能力 m [daN] | L | 滚珠数量 | 滚珠直径 | f | b* | c* | h | x | y |
|----------------|----|-----------------|-----|------|------|-----|----|----|----|----|------|
| 2198.42.18.105 | 18 | 75 | 105 | 3 | 10 | 1.5 | 30 | 12 | 30 | 35 | 14.5 |
| 2198.42.18.140 | 18 | 100 | 140 | 4 | 10 | 1.5 | 30 | 12 | 30 | 35 | 14.5 |
| 2198.42.18.175 | 18 | 125 | 175 | 5 | 10 | 1.5 | 30 | 12 | 30 | 35 | 14.5 |
| 2198.42.18.210 | 18 | 150 | 210 | 6 | 10 | 1.5 | 30 | 12 | 30 | 35 | 14.5 |
| 2198.42.18.280 | 18 | 200 | 280 | 8 | 10 | 1.5 | 30 | 12 | 30 | 35 | 14.5 |
| 2198.42.18.350 | 18 | 250 | 350 | 10 | 10 | 1.5 | 30 | 12 | 30 | 35 | 14.5 |
| 2198.42.22.120 | 22 | 120 | 120 | 3 | 12 | 1.5 | 37 | 16 | 38 | 40 | 14.5 |
| 2198.42.22.160 | 22 | 160 | 160 | 4 | 12 | 1.5 | 37 | 16 | 38 | 40 | 14.5 |
| 2198.42.22.200 | 22 | 200 | 200 | 5 | 12 | 1.5 | 37 | 16 | 38 | 40 | 14.5 |
| 2198.42.22.240 | 22 | 240 | 240 | 6 | 12 | 1.5 | 37 | 16 | 38 | 40 | 14.5 |
| 2198.42.22.320 | 22 | 320 | 320 | 8 | 12 | 1.5 | 37 | 16 | 38 | 40 | 14.5 |
| 2198.42.22.400 | 22 | 400 | 400 | 10 | 12 | 1.5 | 37 | 16 | 38 | 40 | 14.5 |
| 2198.42.28.135 | 28 | 190 | 135 | 3 | 15 | 1.5 | 46 | 20 | 48 | 45 | 19 |
| 2198.42.28.180 | 28 | 250 | 180 | 4 | 15 | 1.5 | 46 | 20 | 48 | 45 | 19 |
| 2198.42.28.225 | 28 | 320 | 225 | 5 | 15 | 1.5 | 46 | 20 | 48 | 45 | 19 |
| 2198.42.28.270 | 28 | 380 | 270 | 6 | 15 | 1.5 | 46 | 20 | 48 | 45 | 19 |
| 2198.42.28.360 | 28 | 500 | 360 | 8 | 15 | 1.5 | 46 | 20 | 48 | 45 | 19 |
| 2198.42.28.450 | 28 | 630 | 450 | 10 | 15 | 1.5 | 46 | 20 | 48 | 45 | 19 |
| 2198.42.36.150 | 36 | 300 | 150 | 3 | 20 | 1.5 | 56 | 25 | 61 | 50 | 24.5 |
| 2198.42.36.200 | 36 | 400 | 200 | 4 | 20 | 1.5 | 56 | 25 | 61 | 50 | 24.5 |
| 2198.42.36.250 | 36 | 500 | 250 | 5 | 20 | 1.5 | 56 | 25 | 61 | 50 | 24.5 |
| 2198.42.36.300 | 36 | 600 | 300 | 6 | 20 | 1.5 | 56 | 25 | 61 | 50 | 24.5 |
| 2198.42.36.400 | 36 | 800 | 400 | 8 | 20 | 1.5 | 56 | 25 | 61 | 50 | 24.5 |
| 2198.42.36.500 | 36 | 1000 | 500 | 10 | 20 | 1.5 | 56 | 25 | 61 | 50 | 24.5 |