

# BALL-LOCK PILOT PIN, WITH PARABOLIC TIP, HEAVY DUTY

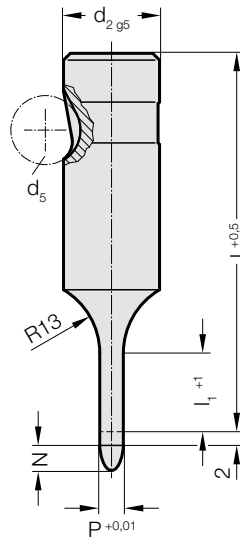

2273.



## 2273. Ball-Lock pilot pin, with parabolic tip, heavy duty

d <sub>2</sub> / Order No	d <sub>5</sub>	P	l <sub>1</sub> / Order No	l (Order Code character)	63 (C)	71 (D)	80 (E)	90 (F)	100 (G)	110 (H)	125 (J)
10 / (2)	10	5,9 - 9,9	19 (2)		●	●	●	●	●		
13 / (3)	12	9,9 - 12,9	19 (2)		●	●	●	●	●	●	●
16 / (4)	12	12,9 - 15,9	25 (3)		●	●	●	●	●	●	●
20 / (5)	12	15,9 - 19,9	25 (3)		●	●	●	●	●	●	●
25 / (6)	12	19,9 - 24,9	25 (3)		●	●	●	●	●	●	●
32 / (7)	12	24,9 - 31,9	25 (3)			●	●	●	●	●	●
40 / (9)	12	31,9 - 39,9	30 (4)				●	●	●	●	●

### Material:

HSS

Hardness 62 ± 2 HRC

### Execution:

Shaft and pilot pin fine ground.  
Special dimensions on request.

### Note:

The 2 mm length provides full guidance before the blanking punch contacts the sheet metal.

### Length of parabolic tip N:

= 8 mm where P ≤ 10 mm  
= 12 mm where P 10,1 mm - 15 mm  
= 15 mm where P > 15 mm

### Ordering Code (example):

**2273.4G3.1410**

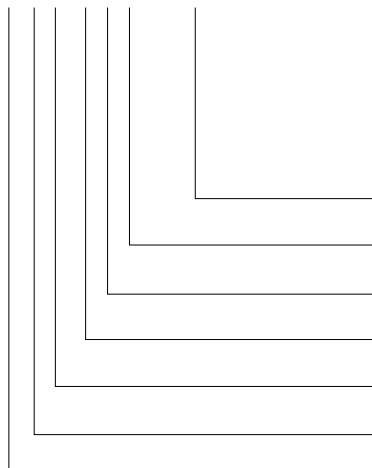

#### Shape: round

P = Ø 14,1 mm

#### Punch cutting length: l<sub>1</sub>

25 mm

#### Length: l

100 mm

#### Diameter: d<sub>2</sub>

16 mm

#### Type:

heavy

#### Execution:

Pilot pin with parabolic tip

#### Punch:

without ejector pin

= 1410

**Order No**

= (3)

**Order Code character**

= (G)

**Order No**

= (4)

**Order No**

= (3)

**Order No**

= (7)

= 22