

# ELECTRIC TRANSPORTER, BLACK LINE

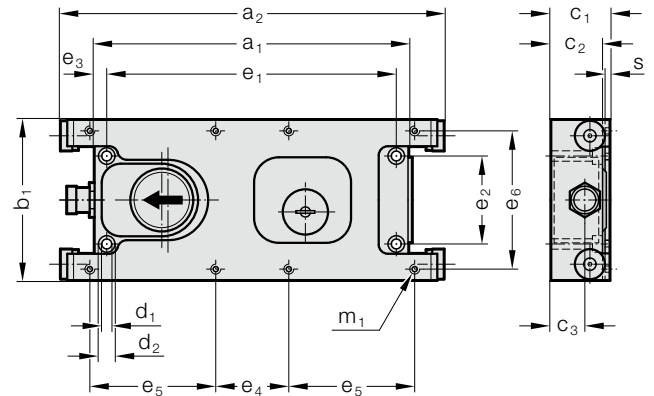

2299.60.1□100.



## Description:

The electric transporter simplifies automation, increases energy efficiency and reduces noise pollution. The speed can be adjusted mechanically and, depending on the task type, the transporter conveys, sorts or separates electrically.

Used predominantly in metal processing and the automotive industry.

## Material:

High-strength steel and anodised aluminium

## Order example:

Order numbers for Transporter electric BLACK LINE **without connection cable** (2299.60.82.0x.xx)

**With** control unit, 230 V:

2299.60.18100.01 MINI

2299.60.14100.01 COMPACT

2299.60.12100.01 MAX

2299.60.10100.02 ULTRA (potential-free output)

Replacement **without** control unit, 230 V:

2299.60.18100.00 MINI

2299.60.14100.00 COMPACT

2299.60.12100.00 MAX

2299.60.10100.00 ULTRA

## Note:

The connection cable, control unit transporter and optionally the signal cable, control unit press are to be ordered separately.

For more information on the electrical connections, control unit and channel fastening, see Accessories.

Socket head screws DIN EN ISO 4762 for fastening the transporter are included in delivery.

## 2299.60. Electric transporter, BLACK LINE

Order No	a <sub>1</sub>	a <sub>2</sub>	b <sub>1</sub>	c <sub>1</sub>	c <sub>2</sub>	c <sub>3</sub>	d <sub>1</sub>	d <sub>2</sub>	e <sub>1</sub>	e <sub>2</sub>	e <sub>3</sub>	e <sub>4</sub>	e <sub>5</sub>	e <sub>6</sub>	m <sub>1</sub>	s
2299.60.18100.00	220	271	118	38.7	33.5	20.9	6.3	10	206	70	7	25	107	100	M5	3
2299.60.14100.00	250	305	128	47	41	27	8.2	13.5	230	70	10	58	100	110	M6	4
2299.60.12100.00	260	316	138	68	61	38	8.2	13.5	238	70	11	58	105	110	M6	5
2299.60.10100.00	260	320	146	78	69	51	8.2	13.5	238	70	29	58	105	110	M6	6

Execution	MINI	KOMPAKT	MAX	ULTRA
Transport weight max. (excl. channel) [kg]	10	20	40	100
Guide channel weight max. [kg]	4	8	16	50
Stroke	20	20	20	20
Conveying speed (mechanically adjustable) [m/min.]	4 - 8	4 - 8	4 - 8	4 - 8
Warning system (motion sensor)	integrated	integrated	integrated	integrated
Start/stop	Controllable via PLC	Controllable via PLC	Controllable via PLC	Controllable via PLC
Motor and overload protection	integrated	integrated	integrated	integrated
Noise emissions [dB-A]	60	60	60	60
Power consumption [kW]	0.05	0.07	0.15	0.25
Electrical connection, control unit	M23	M23	M23	M23
Protection type	IP62	IP62	IP62	IP62
Weight [kg]	2.65	3.7	6.3	9
Temperature range (permissible ambient temperature)	-20 to +100 °C	-20 to +100 °C	-20 to +100 °C	-20 to +100 °C