

DOWEL PIN SIMILAR TO DIN EN ISO 8734

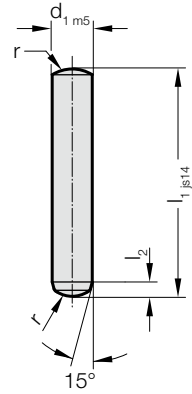

235.1.



Material:

Steel
Hardness 60 ± 2 HRC

Execution:

hardened and ground to finest finish
FIBRO Dowel Pins are manufactured with the exacting requirements of high class diemaking in mind. Whereas DIN EN ISO 8734 stipulates ISO Class 6 for dowels, we produce our pins to m5.

235.1. Dowel pin similar to DIN EN ISO 8734

d ₁	l ₂	r	l ₁	6	8	10	12	14	16	18	20	24	28	32	36	40	45	50	55	60	70	80	90	100	120	130	140
1	0.48	1			●	●	●																				
1.5	0.62	1.6		●	●	●	●	●	●																		
2	0.78	2		●	●	●	●	●	●	●	●	●	●	●													
2.5	0.95	2.5		●	●	●	●	●	●	●	●	●	●	●	●												
3	1.1	3		●	●	●	●	●	●	●	●	●	●	●	●	●	●										
4	1.4	4		●	●	●	●	●	●	●	●	●	●	●	●	●	●	●	●	●							
5	1.7	5			●	●	●	●	●	●	●	●	●	●	●	●	●	●	●	●	●	●					
6	2.1	6				●	●	●	●	●	●	●	●	●	●	●	●	●	●	●	●	●	●	●	●	●	●
8	2.6	8					●	●	●	●	●	●	●	●	●	●	●	●	●	●	●	●	●	●	●	●	●
10	3	10							●	●	●	●	●	●	●	●	●	●	●	●	●	●	●	●	●	●	●
12	3.8	12									●	●	●	●	●	●	●	●	●	●	●	●	●	●	●	●	●
14	3.8	16													●	●	●	●	●	●	●	●	●	●	●	●	
16	4.7	16														●	●	●	●	●	●	●	●	●	●	●	
20	6	20															●	●	●	●	●	●	●	●	●	●	

Ordering Code (example):

Dowel pin similar to DIN EN ISO 8734	=	235.1.
Diameter d ₁	6 mm	= 0600.
Length l ₁	10 mm	= 010
Order No		= 235.1.0600. 010