

DOWEL PIN WITH INTERNAL EXTRACTING THREAD, SIMILAR TO DIN EN ISO 8735

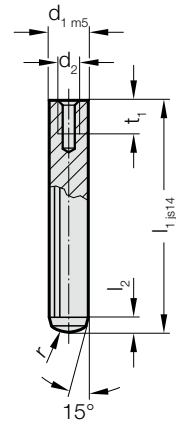

236.1.



Material:

Steel
Hardness 60 ± 2 HRC

Execution:

hardened and ground to finest finish
FIBRO Dowel Pins are manufactured with the exacting requirements of high class diemaking in mind. Whereas DIN EN ISO 8735 stipulates ISO Class 6 for dowels, we produce our pins to m5.

236.1. Dowel pin with internal extracting thread, similar to DIN EN ISO 8735

d ₁	d ₂	t ₁	l ₂	r	l ₁	16	18	20	24	28	32	36	40	45	50	55	60	70	80	90	100	120
6	M4	6	2.1	6		•	•	•	•	•	•	•	•	•	•	•	•	•	•	•	•	•
8	M5	8	2.6	8				•	•	•	•	•	•	•	•	•	•	•	•	•	•	•
10	M6	10	3	10					•	•	•	•	•	•	•	•	•	•	•	•	•	•
12	M6	12	3.8	12						•	•	•	•	•	•	•	•	•	•	•	•	•
14	M8	12	4	16							•	•	•	•	•	•	•	•	•	•	•	•
16	M8	16	4.7	16							•	•	•	•	•	•	•	•	•	•	•	•
20	M10	20	6	20								•	•	•	•	•	•	•	•	•	•	•
25	M16	24	6	25									•	•	•	•	•	•	•	•	•	•

Ordering Code (example):

Dowel pin with internal extracting thread, similar to DIN EN ISO 8735	=	236.1.
Diameter d ₁	14 mm =	1400.
Length l ₁	32 mm =	032
Order No	=	236.1. 1400. 032