

# EJECTOR PIN, HARDENED, ROUND STEPPED, DIN 1530-2 SHAPE C

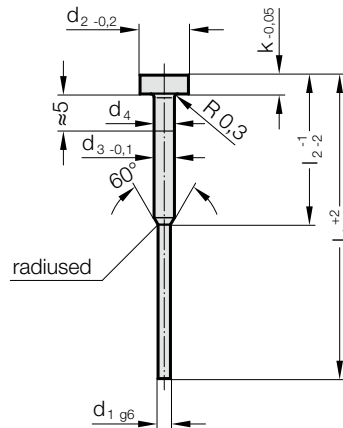

238.1.



**Material:**

WS  
 Order No 238.1.  
 Hardness:  
 Shaft 60 ± 2 HRC  
 Head 45 ± 5 HRC

Description of FIBRO materials for tool and die components see at the beginning of Chapter E.

**Execution:**

Shaft precision ground, hardened.  
 Head hot dipped and tempered.  
 The compression thickening below the head is omitted depending on the manufacturing process.

$d_4$ : For  $d_3 < 5$  mm,  $d_4 = d_3 + 0,03$   
 For  $d_3 \geq 5$  mm,  $d_4 = d_3 + 0,04$   
 for  $d_3 \geq 18$  mm,  $d_4 = d_3 + 0,07$

238.1. Ejector pin, hardened, round stepped, DIN 1530-2 Shape C

$d_1$	$d_2$	$d_3$	k	$l_1$	63	80	100	125	160	200
				$l_2$	30	32	50	50	63	80
0.8	4	2	2		●	●	●	●	●	
0.9	4	2	2		●	●	●	●	●	
1	4	2	2		●	●	●	●	●	●
1.1	4	2	2		●	●	●	●	●	●
1.2	4	2	2		●	●	●	●	●	●
1.3	4	2	2		●	●	●	●	●	●
1.4	4	2	2		●	●	●	●	●	●
1.5	6	3	3		●	●	●	●	●	●
1.6	6	3	3			●	●	●	●	●
1.7	6	3	3			●	●	●	●	●
1.8	6	3	3			●	●	●	●	●
1.9	6	3	3			●	●	●	●	●
2	6	3	3			●	●	●	●	●
2.1	6	3	3				●	●	●	●
2.2	6	3	3				●	●	●	●
2.3	6	3	3				●	●	●	●
2.4	6	3	3				●	●	●	●
2.5	6	3	3				●	●	●	●

**Ordering Code (example):**

Ejector pin, hardened, round stepped, DIN 1530-2 Shape C	=238.1.
Diameter $d_1$	1.7 mm = 0170.
Length $l_1$	80 mm = 080
Order No	=238.1. 0170. 080