

EJECTOR PIN, NITRIDED, ROUND STEPPED, DIN 1530-2 SHAPE C

Material:

NWA
 Order No 238.8.
 Hardness:
 Shaft* ≥ 950 HV 0,3
 Head 45 ± 5 HRC
 Core strength > 1400 N/mm²

 Description of FIBRO materials for tool and die components see at the beginning of Chapter E.

Execution:

Shaft precision ground, nitrided.
 Head hot dipped and tempered.
 The compression thickening below the head is omitted depending on the manufacturing process.

d_4 : For $d_3 < 5$ mm, $d_4 = d_3 + 0,03$
 For $d_3 \geq 5$ mm, $d_4 = d_3 + 0,04$
 for $d_3 \geq 18$ mm, $d_4 = d_3 + 0,07$

238.8.

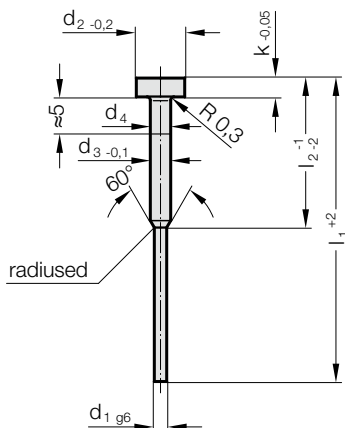

238.8. Ejector pin, nitrided, round stepped, DIN 1530-2 Shape C

d_1	d_2	d_3	k	l_1	l_2	63	80	100	125	160	200
						30	32	50	50	63	80
0.8	4	2	2			●	●	●	●	●	
0.9	4	2	2			●	●	●	●	●	
1	4	2	2			●	●	●	●	●	
1.1	4	2	2			●	●	●	●	●	
1.2	4	2	2			●	●	●	●	●	
1.3	4	2	2			●	●	●	●	●	
1.4	4	2	2			●	●	●	●	●	
1.5	6	3	3			●	●	●	●	●	●
1.6	6	3	3				●	●	●	●	●
1.7	6	3	3				●	●	●	●	●
1.8	6	3	3				●	●	●	●	●
1.9	6	3	3				●	●	●	●	●
2	6	3	3				●	●	●	●	●
2.2	6	3	3				●	●	●	●	●
2.5	6	3	3					●	●	●	●

Ordering Code (example):

Ejector pin, nitrided, round stepped, DIN 1530-2 Shape C	=238.8.
Diameter d_1	1.5 mm = 0150.
Length l_1	63 mm = 063
Order No	=238.8. 0150. 063