

DAMPING UNIT SD

2452.10. .2

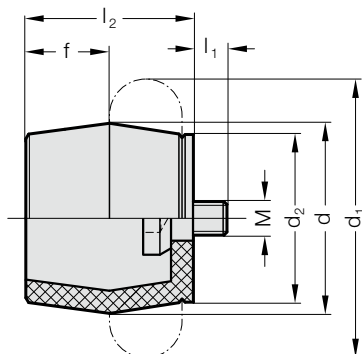

Material:

Damping unit SD: CO polyester elastomer, 55 Shore D
Screw: Steel

Technical data:

Resistant to microbes, seawater, and chemicals, as well as very good UV and ozone resistance. No water absorption and no bloating.

Starting speed: up to max. 5 m/s

Installation position: any

Dynamic power consumption: 870 N through 90000 N

Permissible temperature range: -40 °C through 90 °C

Dissipation of energy: 40 % through 66 %

Note:

We are happy to support you in the calculation and design of a suitable damping unit.

Dynamic ($v > 0.5$ m/s) characteristic curves available for all types upon request.

SD damping units can also be used for emergency stop applications.

Further information upon request.

2452.10. .2 Damping unit SD

Order No	d	l_2	d_1	d_2	f	W_3 [Nm/stroke]*	M	l_1	Tightening torque [Nm]
2452.10.012.011.2	12	11	15	11	4	2	M3	3	1
2452.10.017.016.2	17	16	22	15	6	6	M4	4	1.7
2452.10.021.018.2	21	18	26	18	7	10	M5	5	2.3
2452.10.022.019.2	22	19	27	19	6	11.5	M6	6	6
2452.10.028.026.2	28	26	36	25	9	29	M6	6	6
2452.10.034.030.2	34	30	43	30	10	48	M6	6	6
2452.10.037.033.2	37	33	48	33	12	65	M6	6	6
2452.10.040.035.2	40	35	50	34	14	82	M8	8	20
2452.10.043.038.2	43	38	55	38	14	112	M8	8	20
2452.10.047.041.2	47	41	60	41	17	140	M12	12	50
2452.10.050.045.2	50	45	64	44	19	170	M12	12	50
2452.10.054.047.2	54	47	68	47	17	201	M12	12	50
2452.10.057.051.2	57	51	73	50	21	242	M12	12	50
2452.10.062.054.2	62	54	78	53	21	304	M12	12	50
2452.10.065.058.2	65	58	82	57	22	374	M12	12	50
2452.10.070.061.2	70	61	86	60	24	421	M12	12	50
2452.10.072.065.2	72	65	91	63	26	482	M16	16	120
2452.10.080.069.2	80	69	100	69	23	570	M16	16	120
2452.10.082.074.2	82	74	105	72	28	683	M16	16	120
2452.10.085.076.2	85	76	110	75	27	797	M16	16	120
2452.10.090.080.2	90	80	114	78	30	934	M16	16	120
2452.10.098.086.2	98	86	123	85	31	1,147	M16	16	120
2452.10.116.101.2	116	101	146	98	38	2,014	M16	16	120

*Energy absorption per stroke under permanent load