

# SLIDE STOP, AS PER VW

2452.10.55.

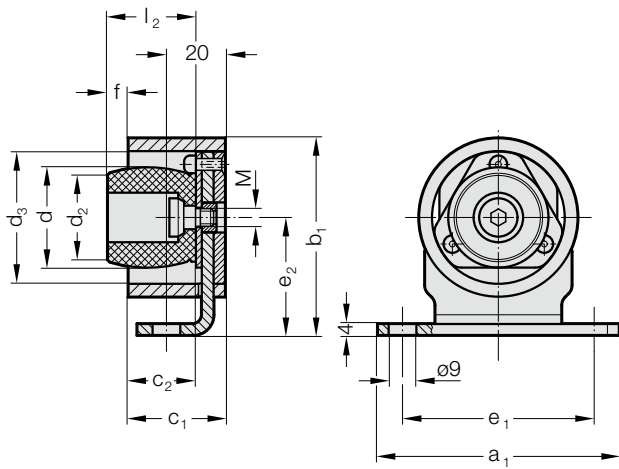

## Material:

Retainer: Steel

SD damping element: Copolyester elastomer, 55 Shore D

## Note:

Screws are not included.

Order No for spare part: Damping unit SD, with screw 2452.10.034.030.2

For the exchange of the damping unit, the screw tightening torque for the holding screw is 6 Nm.

## Fixing:

Use socket cap screws DIN EN ISO 4762 M8.

## Mounting example

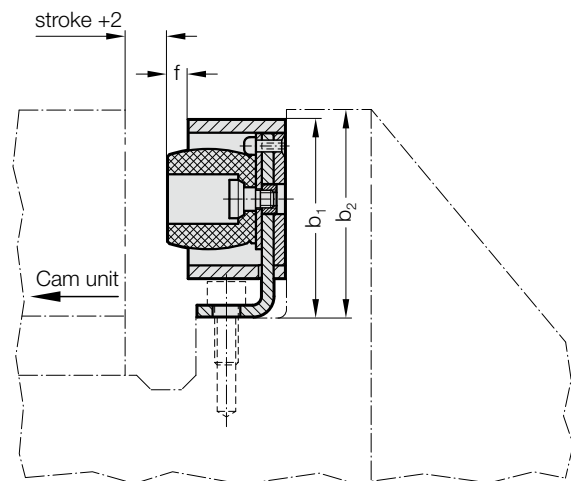

## 2452.10.55. Slide stop, as per VW

Order No	d	d <sub>2</sub>	d <sub>3</sub>	M	a <sub>1</sub>	b <sub>1</sub>	b <sub>2</sub>	c <sub>1</sub>	c <sub>2</sub>	e <sub>1</sub>	e <sub>2</sub>	l <sub>2</sub>	f	Spring force [N]	Energy absorption per stroke under permanent load [Nm]
2452.10.55.034	34	30	45	M6	82	67	70	33	23	65	40	30	7	6,000	27