

COMPACT GAS SPRING

Note:

Initial spring force at 150 bar = 1000 daN

Order No for spare parts kit: 2490.14.01000

Gas spring without valve

Order No (example): 2490.14.01000. .P

When mounting to floor, contact over the entire floor of the cylinder tube must be ensured! Before fitting the adapter base plate remove the valve from the gas spring. If vibration occurs, tighten the fixing screws accordingly.

Pressure medium: Nitrogen N₂

Max. filling pressure: 150 bar

Min. filling pressure: 25 bar

Working temperature: 0°C to +80°C

Temperature related force increase: ± 0.3%/°C

Max. recommended extensions per minute:

approx. 100 (at 20°C)

Max. piston speed: 0.8 m/s

2490.14.01000.

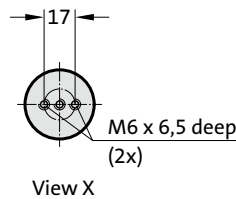
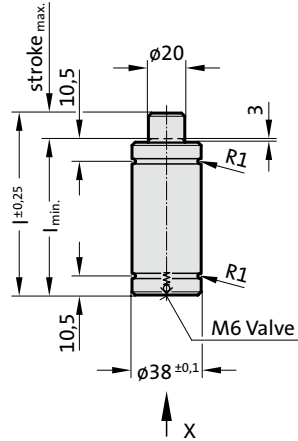

2490.14.01000.

Compact gas spring

Order No	Stroke _{max.} (s)	l _{min.}	l	g ₂ *
2490.14.01000.006	6	55	61	49
2490.14.01000.010	10	68	78	62
2490.14.01000.016	16	84	100	78
2490.14.01000.025	25	110	135	104
2490.14.01000.032	32	135	167	129
2490.14.01000.040	40	155	195	149
2490.14.01000.050	50	180	230	174

*see mounting example

2480.00.20.01000

Adapter baseplate with connecting fitting, without valve (only for use with composite connections)

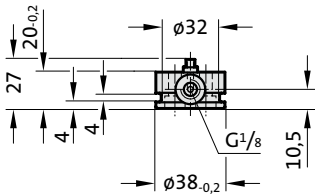
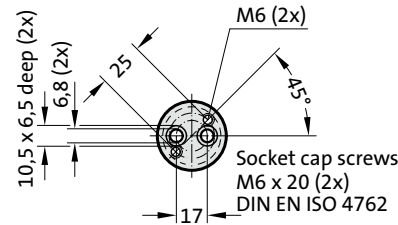

Initial spring force versus charge pressure

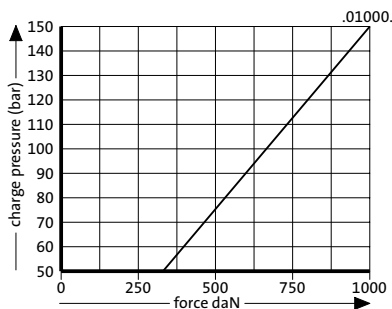

Spring force Diagram displacement versus stroke rise

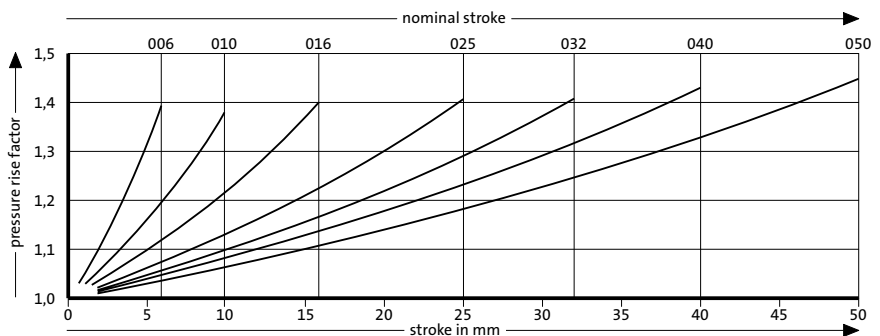

Pressure rise factor accounts for displacement but not external influences!