

SLIDING PAD, STEEL WITH SINTERLAYER, VDI 3357

2960.32.

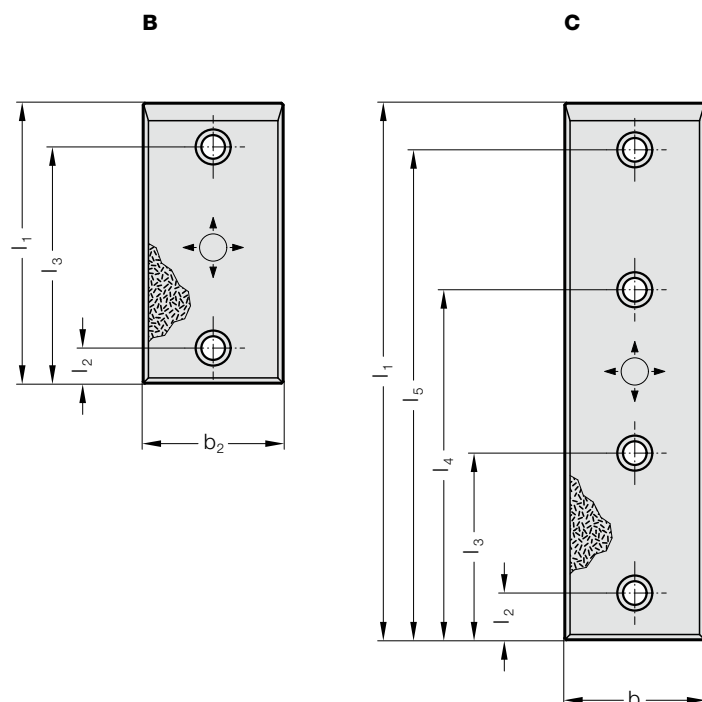

2960.32.

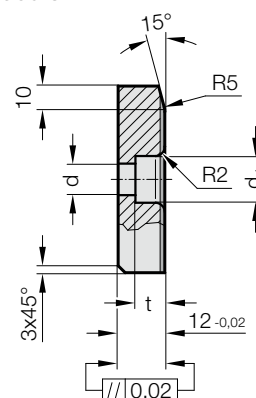

2960.32. Sliding pad, Steel with sinterlayer, VDI 3357

Order No	Shape	b	l ₁	l ₂	l ₃	l ₄	l ₅	d	d ₁	t	Number of screw holes
2960.32.030.080	B	30	80	25	55	-	-	9	15	9	2
2960.32.030.100	B	30	100	25	75	-	-	9	15	9	2
2960.32.030.125	B	30	125	25	100	-	-	9	15	9	2
2960.32.030.160	B	30	160	25	135	-	-	9	15	9	2
2960.32.030.200	B	30	200	25	175	-	-	9	15	9	2
2960.32.040.080	B	40	80	25	55	-	-	9	15	9	2
2960.32.040.100	B	40	100	25	75	-	-	9	15	9	2
2960.32.040.125	B	40	125	25	100	-	-	9	15	9	2
2960.32.040.160	B	40	160	25	135	-	-	9	15	9	2
2960.32.040.200	B	40	200	25	175	-	-	9	15	9	2
2960.32.050.080	B	50	80	25	55	-	-	9	15	9	2
2960.32.050.100	B	50	100	25	75	-	-	9	15	9	2
2960.32.050.125	B	50	125	25	100	-	-	9	15	9	2
2960.32.050.160	B	50	160	25	135	-	-	9	15	9	2
2960.32.050.200	B	50	200	25	175	-	-	9	15	9	2
2960.32.050.250	C	50	250	25	85	165	225	9	15	9	4
2960.32.050.300	C	50	300	25	105	195	275	9	15	9	4
2960.32.050.350	C	50	350	25	125	225	325	9	15	9	4
2960.32.050.400	C	50	400	25	145	255	375	9	15	9	4
2960.32.060.080	B	60	80	25	55	-	-	9	15	9	2
2960.32.060.100	B	60	100	25	75	-	-	9	15	9	2
2960.32.060.125	B	60	125	25	100	-	-	9	15	9	2
2960.32.060.160	B	60	160	25	135	-	-	9	15	9	2
2960.32.060.200	B	60	200	25	175	-	-	9	15	9	2
2960.32.080.080	B	80	80	25	55	-	-	9	15	9	2
2960.32.080.100	B	80	100	25	75	-	-	9	15	9	2
2960.32.080.125	B	80	125	25	100	-	-	9	15	9	2
2960.32.080.160	B	80	160	25	135	-	-	9	15	9	2
2960.32.080.200	B	80	200	25	175	-	-	9	15	9	2

Description:

Steel with sinterlayer is a two-layer material. It ensures low maintenance, selflubricating service even in arduous multishift applications.

Material:

Steel plate with sinterlayer, part of lubricant 20-25%.

Note:

Screws are not included.

Fixing:

Use socket cap screws DIN EN ISO 4762 M8.