

PLAQUE DE FROTTEMENT, ACIER AVEC RAINURE DE GRAISSAGE, CNOMO

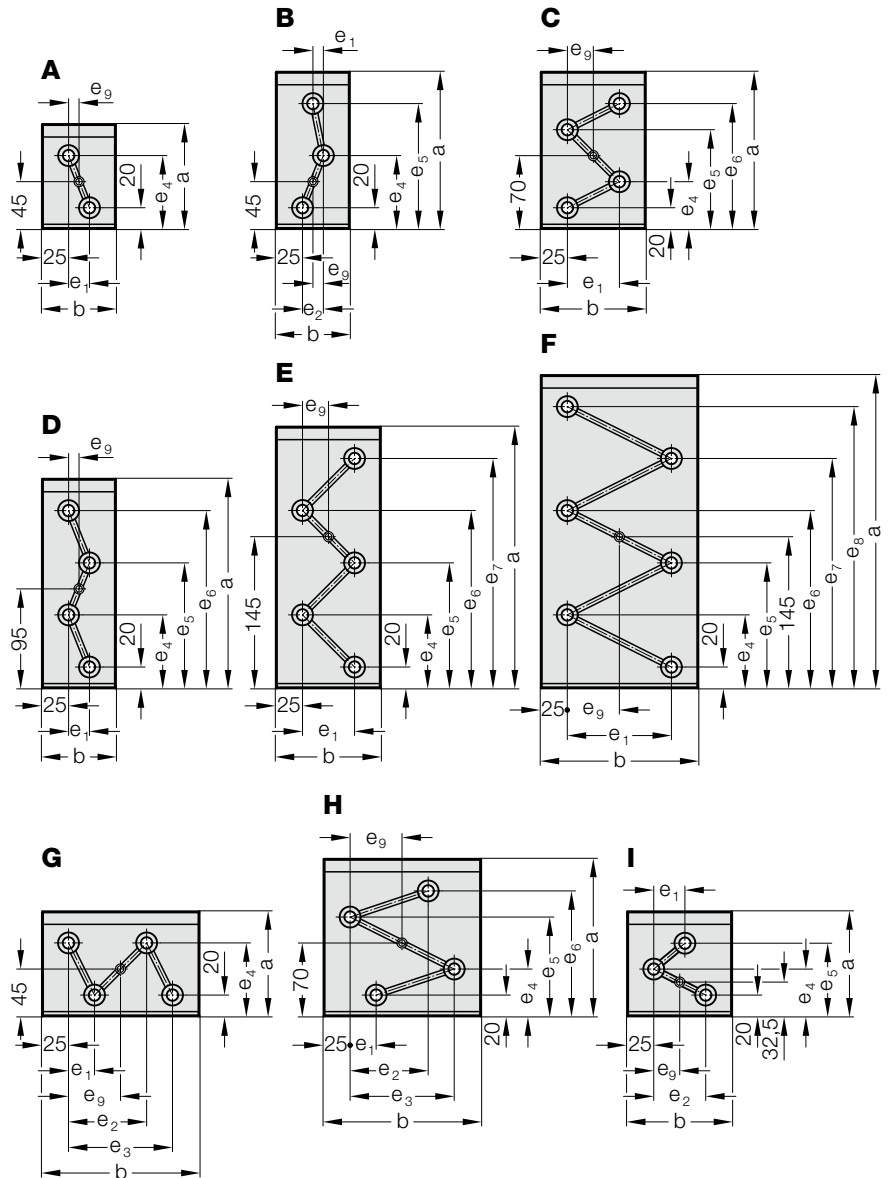

2960.44.45.



Matière :
Acier, trempé superficiellement

Remarque :
Livraison sans les vis.

Fixation :
Utiliser des vis à tête cylindrique
DIN EN ISO 4762 M10.

2960.44.45.

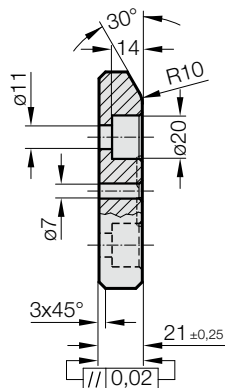

PLAQUE DE FROTTEMENT, ACIER AVEC RAINURE DE GRAISSAGE, CNOMO

2960.44.45. Plaque de frottement, Acier avec rainure de graissage, CNOMO

| N° de commande | Forme | b | a | e | e ₁ | e ₂ | e ₃ | e ₄ | e ₅ | e ₆ | e ₇ | e ₈ | e ₉ | Nombre de perçages |
|--------------------|-------|-----|-----|-----|----------------|----------------|----------------|----------------|----------------|----------------|----------------|----------------|----------------|--------------------|
| 2960.44.45.070.100 | A | 70 | 100 | 20 | - | - | - | 70 | - | - | - | - | 10 | 2 |
| 2960.44.45.070.150 | B | 70 | 150 | 10 | 20 | - | - | 70 | 120 | - | - | - | 10 | 3 |
| 2960.44.45.070.200 | D | 70 | 200 | 20 | - | - | - | 70 | 120 | 170 | - | - | 10 | 4 |
| 2960.44.45.100.100 | I | 100 | 100 | 30 | 50 | - | - | 45 | 70 | - | - | - | 25 | 3 |
| 2960.44.45.100.150 | C | 100 | 150 | 50 | - | - | - | 45 | 95 | 120 | - | - | 25 | 4 |
| 2960.44.45.100.200 | D | 100 | 200 | 50 | - | - | - | 70 | 120 | 170 | - | - | 25 | 4 |
| 2960.44.45.100.250 | E | 100 | 250 | 50 | - | - | - | 70 | 120 | 170 | 220 | - | 25 | 5 |
| 2960.44.45.100.300 | F | 100 | 300 | 50 | - | - | - | 70 | 120 | 170 | 220 | 270 | 25 | 6 |
| 2960.44.45.150.100 | G | 150 | 100 | 25 | 75 | 100 | - | 70 | - | - | - | - | 50 | 4 |
| 2960.44.45.150.150 | H | 150 | 150 | 25 | 75 | 100 | - | 45 | 95 | 120 | - | - | 50 | 4 |
| 2960.44.45.150.200 | D | 150 | 200 | 100 | - | - | - | 70 | 120 | 170 | - | - | 50 | 4 |
| 2960.44.45.150.250 | E | 150 | 250 | 100 | - | - | - | 70 | 120 | 170 | 220 | - | 50 | 5 |
| 2960.44.45.150.300 | F | 150 | 300 | 100 | - | - | - | 70 | 120 | 170 | 220 | 270 | 50 | 6 |
| 2960.44.45.200.100 | G | 200 | 100 | 50 | 100 | 150 | - | 70 | - | - | - | - | 75 | 4 |