

GUIDE BAR WITH TWO SLIDING SURFACES, BRONZE WITH SOLID LUBRICANT, CNOMO

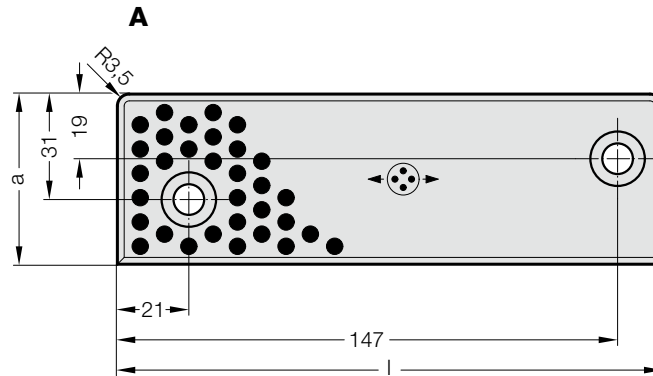

2962.75.45.



2962.75.45.

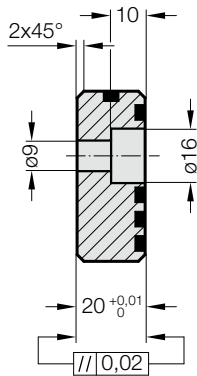

B

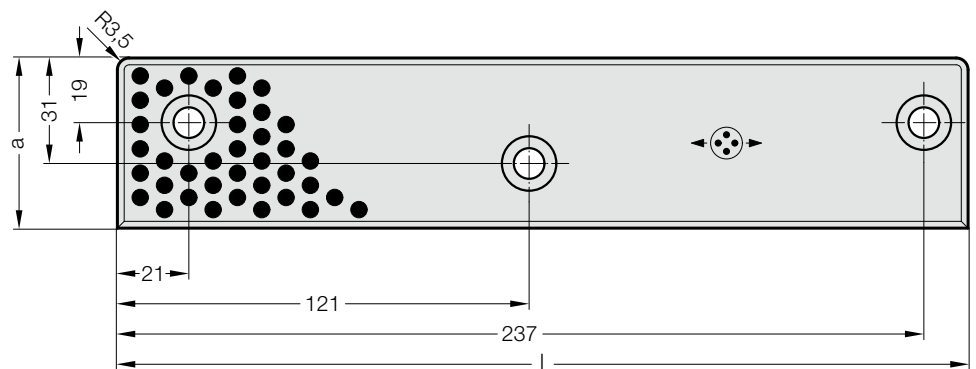

Material:

Bronze with solid lubricant, oilless lubricating

Note:

Screws are not included.

Fixing:

Use socket cap screws
DIN EN ISO 4762 M8.

2962.75.45. Guide bar with two sliding surfaces, Bronze with solid lubricant, CNOMO

Order No	Shape	a	l	Number of screw holes
2962.75.45.050.20.160	A	50	160	2
2962.75.45.050.20.250	B	50	250	3