

Blindnietmutter ALUMINIUM



Blindnietmutter AFM Serie 10.850



EN AW - 5754 [AlMg3]

Aluminium

- > Flachkopf
- > Rundschaft
- > offen

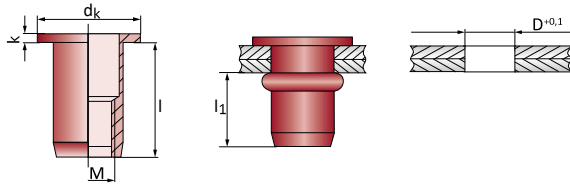

| M | \pm | I | Nr. | |
|--------------|--------------|----------------|-------------------------------|------------------------------------|
| M3 | 0,3 - 2,0 | 8,5 | 10.850.030.200 | 500 |
| | 2,0 - 3,5 | 11,2 | 10.850.030.350 | 500 |
| D 5,0 | k 0,8 | dk 7,0 | l₁ max. 6,0 | \odot 1 Nm \updownarrow 1500 N |
| M4 | 0,5 - 3,0 | 11,0 | 10.850.040.300 | 500 |
| | 2,5 - 4,0 | 12,0 | 10.850.040.400 | 500 |
| | 3,0 - 5,0 | 13,2 | 10.850.040.500 | 500 |
| D 6,0 | k 0,8 | dk 10,0 | l₁ max. 8,0 | \odot 3 Nm \updownarrow 2600 N |
| M5 | 0,5 - 3,0 | 12,0 | 10.850.050.300 | 500 |
| | 2,5 - 4,5 | 13,5 | 10.850.050.450 | 500 |
| | 4,0 - 6,0 | 15,0 | 10.850.050.600 | 500 |
| D 7,0 | k 1,0 | dk 11,0 | l₁ max. 9,0 | \odot 4 Nm \updownarrow 4300 N |

| M | \pm | I | Nr. | |
|---------------|--------------|----------------|--------------------------------|--------------------------------------|
| M6 | 0,5 - 3,0 | 14,5 | 10.850.060.300 | 500 |
| | 3,0 - 4,5 | 16,0 | 10.850.060.450 | 500 |
| D 9,0 | k 1,5 | dk 13,0 | l₁ max. 11,0 | \odot 6 Nm \updownarrow 6700 N |
| M8 | 0,5 - 3,0 | 17,0 | 10.850.080.300 | 500 |
| | 3,0 - 5,5 | 19,5 | 10.850.080.550 | 500 |
| | 5,5 - 7,5 | 21,5 | 10.850.080.750 | 500 |
| D 11,0 | k 1,5 | dk 16,0 | l₁ max. 13,5 | \odot 18 Nm \updownarrow 11000 N |
| M10 | 1,0 - 4,0 | 22,0 | 10.850.100.400 | 250 |
| | 3,0 - 6,0 | 24,0 | 10.850.100.600 | 250 |
| D 13,0 | k 2,0 | dk 19,0 | l₁ max. 16,5 | \odot 28 Nm \updownarrow 17500 N |
| M12 | 1,0 - 4,0 | 24,0 | 10.850.120.400 | 100 |
| | 3,5 - 7,0 | 27,0 | 10.850.120.700 | 100 |
| D 16,0 | k 2,0 | dk 23,0 | l₁ max. 18,5 | \odot 45 Nm \updownarrow 28000 N |

Beachten Sie die OPTO-Mehrbereichs-Blindnietmuttern auf

► Seite 98.



Blindnietmutter AFM-G Serie 10.854

Aluminium

- > Flachkopf
- > Rundschaft
- > geschlossen

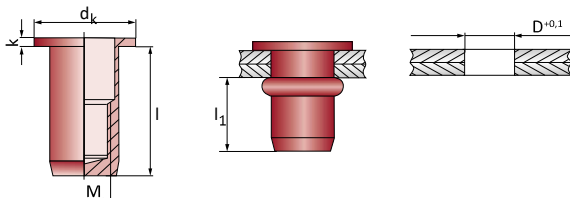

EN AW - 5754 [AlMg3]

| M | \pm | I | Nr. | |
|--------------|--------------|----------------|--------------------------------|------------------------------------|
| M4 | 0,3 - 2,0 | 16,0 | 10.854.040.200 | 500 |
| | 2,0 - 3,0 | 16,5 | 10.854.040.300 | 500 |
| D 6,0 | k 0,8 | dk 10,0 | l₁ max. 13,5 | \odot 3 Nm \updownarrow 2600 N |
| M5 | 0,3 - 3,0 | 18,5 | 10.854.050.300 | 500 |
| | 3,0 - 4,0 | 19,5 | 10.854.050.400 | 500 |
| D 7,0 | k 1,0 | dk 11,0 | l₁ max. 15,5 | \odot 4 Nm \updownarrow 4300 N |
| M6 | 0,5 - 3,0 | 22,0 | 10.854.060.300 | 500 |
| | 3,0 - 4,5 | 23,5 | 10.854.060.450 | 500 |
| D 9,0 | k 1,5 | dk 13,0 | l₁ max. 18,5 | \odot 6 Nm \updownarrow 6700 N |

| M | \pm | I | Nr. | |
|---------------|--------------|----------------|--------------------------------|--------------------------------------|
| M8 | 0,5 - 3,0 | 26,5 | 10.854.080.300 | 250 |
| | 3,0 - 5,5 | 29,0 | 10.854.080.550 | 250 |
| D 11,0 | k 1,5 | dk 16,0 | l₁ max. 23,0 | \odot 18 Nm \updownarrow 11000 N |
| M10 | 1,0 - 3,0 | 32,5 | 10.854.100.300 | 250 |
| | 3,0 - 4,5 | 34,0 | 10.854.100.450 | 250 |
| D 13,0 | k 2,0 | dk 19,0 | l₁ max. 28,5 | \odot 28 Nm \updownarrow 17500 N |

► Informationen über zusätzliche Abdichtungsmöglichkeiten für geschlossene Blindnietmuttern finden Sie im Kapitel Blindnietmutter auf den Seiten 66 und 111.

! Nutzen Sie auch die klassische Kurzbezeichnung unserer Blindnietmuttern für Ihre Anfrage oder Bestellung, die sich wie nebenstehend zusammensetzt:

Serienname: **AFM**
 + Gewindegröße: **M6**
 + maximaler Klemmbereich: **3,0 mm**
 = Kurzbezeichnung: **AFM 6-30**