



# Blind Rivet Nut SFM

## Series 10.852

### Steel

- > Flat Head
- > Round Shank
- > Open

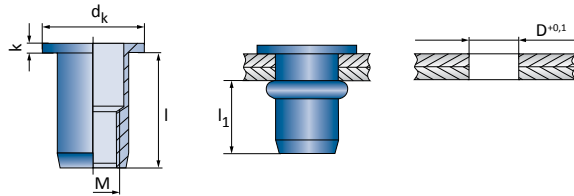

C4C [1.0303]

M		I	No.	
<b>M3</b>	0,5 - 2,0	9,8	10.852.030.200	500
	2,0 - 3,5	11,5	10.852.030.350	500
<b>D 5,0</b>	<b>k 0,8</b>	<b>dk 7,0</b>	<b>l<sub>1</sub> max. 7,0</b>	1,2 Nm  4000 N
<b>M4</b>	1,5 - 3,0	11,0	10.852.040.300	500
	2,0 - 4,0	12,0	10.852.040.400	500
	2,5 - 5,0	14,0	10.852.040.500	500
<b>D 6,0</b>	<b>k 0,8</b>	<b>dk 10,0</b>	<b>l<sub>1</sub> max. 8,0</b>	4 Nm  5200 N
<b>M5</b>	0,5 - 3,0	12,0	10.852.050.300	500
	3,0 - 5,0	15,0	10.852.050.500	500
<b>D 7,0</b>	<b>k 1,0</b>	<b>dk 11,0</b>	<b>l<sub>1</sub> max. 9,0</b>	6 Nm  9500 N
<b>M6</b>	0,5 - 3,0	14,5	10.852.060.300	500
	3,0 - 5,0	16,0	10.852.060.500	500
	4,5 - 6,0	17,5	10.852.060.600	500
<b>D 9,0</b>	<b>k 1,5</b>	<b>dk 13,0</b>	<b>l<sub>1</sub> max. 11,0</b>	11 Nm  16500 N

NEW  
NEW

NEW

M		I	No.	
<b>M8</b>	0,5 - 3,0	17,0	10.852.080.300	250
	3,0 - 5,5	19,5	10.852.080.550	250
	5,5 - 7,5	21,5	10.852.080.750	250
	7,0 - 9,0	24,5	10.852.080.900	250
<b>D 11,0</b>	<b>k 1,5</b>	<b>dk 16,0</b>	<b>l<sub>1</sub> max. 13,5</b>	24 Nm  23500 N
<b>M10</b>	1,0 - 3,0	20,5	10.852.100.300	250
	3,0 - 4,5	22,0	10.852.100.450	250
	3,5 - 6,0	23,5	10.852.100.600	250
<b>D 13,0</b>	<b>k 2,0</b>	<b>dk 19,0</b>	<b>l<sub>1</sub> max. 16,5</b>	50 Nm  37000 N
<b>M12</b>	1,0 - 4,0	25,0	10.852.120.400	100
	3,5 - 7,0	30,0	10.852.120.700	100
<b>D 16,0</b>	<b>k 2,0</b>	<b>dk 23,0</b>	<b>l<sub>1</sub> max. 16,5</b>	82 Nm  54000 N

NEW