



Einnietmutter V-A

Serie 10.455

Stahl

> verzinkt

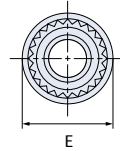
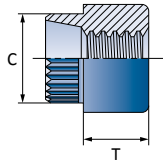

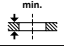
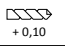
M	 + 0,10	E	T	C	 + 0,10	Nr.
M3	1,1-1,3	7,9	3,2	5,8	5,9	10.455.030.006
	1,4-1,6					10.455.030.008
	1,7-1,9					10.455.030.010
	2,0-2,2					10.455.030.012
	2,9-3,1					10.455.030.016
M4	0,9-1,0	9,5	3,8	6,9	6,95	10.455.040.004
	1,1-1,3					10.455.040.006
	1,4-1,6					10.455.040.008
	1,7-1,9					10.455.040.010
	2,0-2,2					10.455.040.012
	2,9-3,1					10.455.040.016

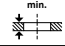
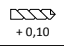
M	 + 0,10	E	T	C	 + 0,10	Nr.
M5	1,4-1,6	11,1	4,4	8,3	8,35	10.455.050.008
	1,7-1,9					10.455.050.010
	2,0-2,2					10.455.050.012
	2,9-3,1					10.455.050.016
M6	1,1-1,3	12,7	5,7	9,5	9,65	10.455.060.006
	2,0-2,2					10.455.060.012