



Connector gland

for connector cut-outs (24-pole)

For the entry of 2 pre-assembled cables in the connector cut-out, without dismantling the connector.

For cable diameter from 8 – 36 mm.

Packs of	Model No. SZ
1 set	2400.000

Material:

Plastic

Clamp terminals:

Sheet steel, zinc-plated, passivated

Supply includes:

1 set =

2 half-shells, including seals, with fastening clamp.



Connector gland

For pre-assembled cables with connectors.

- For material thickness of up to 4 mm.
- Strain relief of the pre-assembled cables can be achieved with cable ties.

Material:

Plastic

Colour:

RAL 9005

Protection category:

IP 65 subject to correct mounting.

Supply includes:

Assembly parts.

To fit	Packs of	Model No. SZ
2 cables Ø 6 to Ø 8 mm	1	2400.300
3 cables Ø 4 to Ø 6 mm	5	2400.500

German patent no. 199 08 657



Rittal service:

The cut-outs may be made by our service centres.

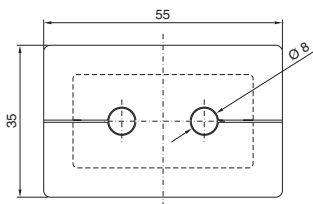

SZ 2400.300

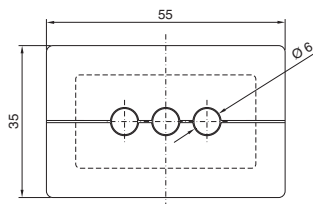

SZ 2400.500

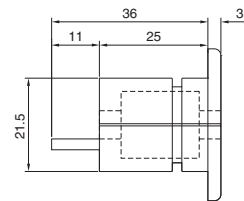

Mounting cut-out

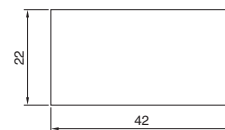
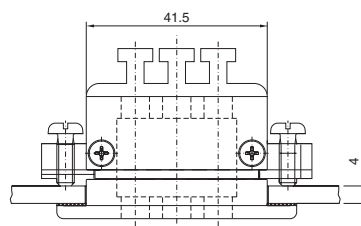
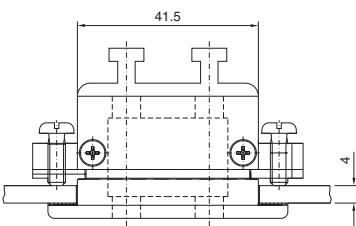

Adaptor plate

for connector entry

To fit

- IW worktop, prepared for turntable or enclosure attachment
 - Operating housing with mounting cut-out CPL, round
 - Surfaces
- With 4 studs M6 x 45 mm.

Material:

Sheet steel, zinc-plated, passivated.

Supply includes:

Seal and assembly parts.

Packs of	Model No. IW
1	6902.660



Also required:

Connector grommet
SZ 2400.300 or SZ 2400.500,
see page 1057.