

# Schiedel ICS25

## Base support plate with drain

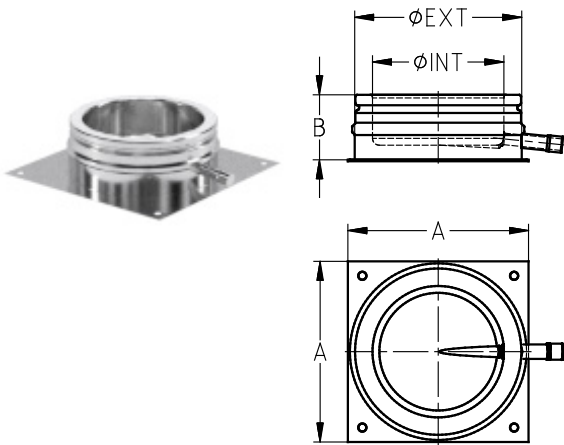

ØINT mm	ØEXT mm	A mm	B mm	Weight kg	Material
80	130	200	90	1.17	101320
80	130	200	90	1.17	148390
100	150	200	90	1.28	101321
100	150	200	90	1.28	148391
130	180	250	90	1.82	100987
130	180	250	90	1.82	104557
150	200	250	90	1.95	100988
150	200	250	90	1.95	104558
180	230	250	90	2.16	100989
200	250	333	90	3.08	100990
230	280	333	90	3.31	101322
250	300	350	90	3.65	100991
250	300	350	90	3.65	104559
300	350	400	90	4.68	100992
300	350	400	90	4.68	104560
350	400	450	90	5.83	100993
400	450	550	90	10.57	101323
450	500	600	90	11.94	101324
500	550	650	90	13.49	101325
600	650	750	90	17.23	101326
700	750	850	90	19.47	101327

**Top plate with drainpoint**

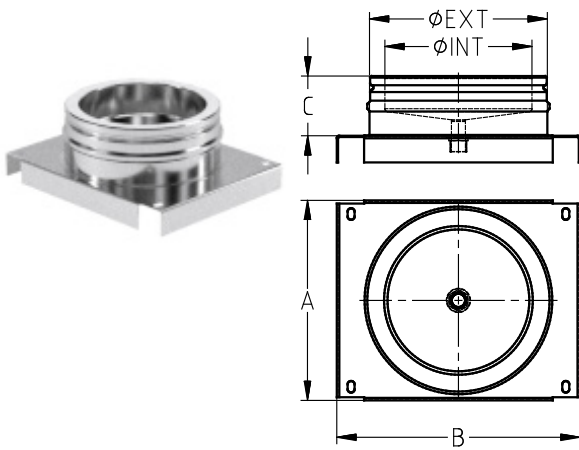

ØINT mm	ØEXT mm	A mm	B mm	C mm	Weight kg	Material
80	130	188	256	95	1.34	101014
100	150	208	276	95	1.68	101015
130	180	238	306	95	2.19	101016
150	200	258	326	95	2.53	101017
180	230	278	356	95	3.03	101018
200	250	285	353	95	3.37	101019
230	280	315	383	95	3.88	101337
250	300	335	403	95	4.22	101020
300	350	385	453	95	5.06	101021
350	400	435	503	95	5.9	101022
400	450	485	553	95	6.56	101023
450	500	535	603	95	7.38	101024
500	550	585	653	95	8.2	101025
600	650	685	753	95	9.84	101026
700	750	785	853	95	11.48	101027

**Application:**

This item may be used at the base of a Wall mounted Vertical Chimney in combination with a Pair of Side Plates or Cantilever brackets (see below). It can also be used as a top plate in combination with a Teleopic

# Schiedel ICS25

## Drain\_Plug\_Supp.

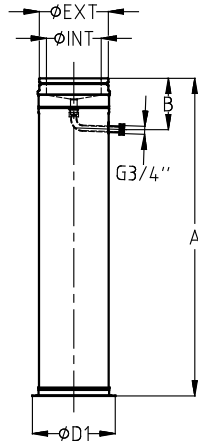

ØINT mm	ØEXT mm	A mm	B mm	D1 mm	Weight kg	Material
80	130	1045	160	176	2.41	101328
80	130	1045	160	176	2.41	148388
100	150	1045	160	196	2.71	101329
100	150	1045	160	196	2.71	148389
130	180	1045	160	226	3.05	100994
150	200	1045	160	246	3.44	100995
180	230	1045	160	276	4.07	100996
200	250	1045	160	296	4.51	100997
230	280	1045	160	326	7.38	101330
250	300	1045	160	346	5.69	100998
300	350	1045	160	401	7.01	100999
350	400	1045	160	419	8.44	101000

### Application:

This item is used at the base of the vertical chimney. It is supplied complete with a drainplug and 3/4" drain point connector. The pipe length can be cut down to size on site. (See load bearing section)

## Schiedel ICS25

### Tee plug with drain

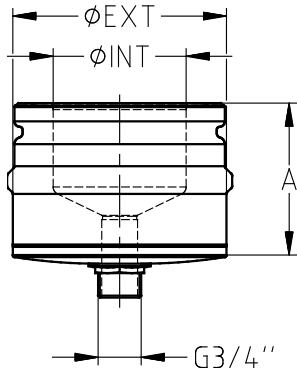

ØINT mm	ØEXT mm	A mm	Weight kg	Material
80	130	95	1.01	101028
80	130	95	1.01	148407
100	150	95	1.35	101029
100	150	95	1.35	148408
130	180	95	1.7	101030
150	200	95	1.94	101031
180	230	95	2.33	101032
200	250	95	2.61	101033
230	280	95	3.1	101338
250	300	95	3.36	101034
300	350	95	4.09	101035
350	400	95	4.7	101036
400	450	95	5.09	101037
450	500	95	5.24	101038
500	550	95	5.58	101039
600	650	95	6.52	101040
700	750	95	8.23	101041

**Application:**

This item is used at the base of the vertical chimney to provide a drain off point for rainwater and condensate. It also provides inspection or cleaning access. It may be used in both dry and wet conditions and on both

## Schiedel ICS25

### Trap. with Inspection

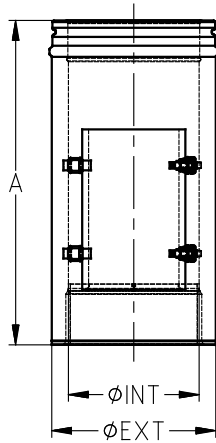

ØINT mm	ØEXT mm	A mm	Weight kg	Material
130	180	497	3.29	104454
150	200	497	3.92	104455
180	230	497	4.7	104456
200	250	497	5.37	104457
230	280	497	5.33	137256
250	300	497	6.04	117763
300	350	497	6.73	137257

### Inspec. Tee N1

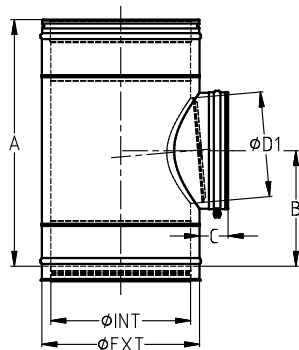

ØINT mm	ØEXT mm	A mm	B mm	C mm	D1 mm	Nominal length mm	Weight kg	Material
150	200	455	205	80	150	500	3.29	116242
180	230	455	205	80	150	500	3.68	116703
200	250	455	205	80	200	500	4.71	116957
230	280	455	205	80	200	500	5.15	120546
250	300	455	205	80	250	500	6.88	100912
300	350	485	225	80	300	530	7.73	100913
350	400	535	253	80	300	580	9.16	100914
400	450	705	330	80	300	750	15.72	134858
450	500	705	330	80	300	750	17.26	134859
500	550	705	330	80	300	750	18.82	134860
600	650	705	330	80	300	750	23.19	134861
700	750	705	330	80	300	750	26.5	134862

Application:

This item is used to provide an inspection or cleaning access on dry or FU applications under negative pressure conditions (N1).

## Schiedel ICS25

### Inspec. Tee P1

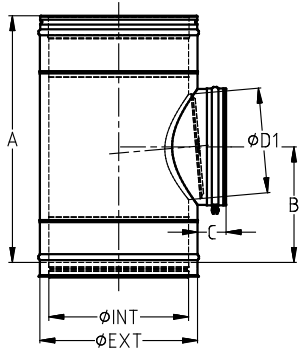

ØINT mm	ØEXT mm	A mm	B mm	C mm	D1 mm	Nominal length mm	Weight kg	Material
150	200	455	205	80	150	500	3.29	116246
180	230	455	205	80	150	500	3.68	116702
200	250	455	205	80	200	500	4.71	116956
230	280	455	205	80	200	500	5.15	117340
250	300	455	205	80	250	500	6.88	100899
300	350	485	225	80	300	530	7.73	100900
350	400	535	253	80	300	580	9.16	100901
400	450	705	330	80	300	750	15.72	134865
450	500	705	330	80	300	750	17.26	134866
500	550	705	330	80	300	750	18.82	134867
600	650	705	330	80	300	750	23.19	134868
700	750	705	330	80	300	750	26.5	134869

Application:

This item is used to provide an inspection or cleaning access on Wet applications under positive pressure conditions (P1).

### Inspec. Tee N1 Short

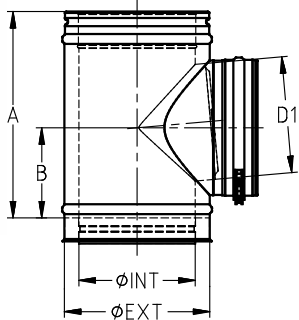

ØINT mm	ØEXT mm	A mm	B mm	D1 mm	Nominal length mm	Weight kg	Material
80	130	288	121	80	333	1.97	101305
100	150	288	121	100	333	2.27	101306
130	180	288	121	130	333	1.76	100907
150	200	305	130	150	350	2.21	100908
180	230	305	130	150	350	2.46	100909
200	250	355	155	200	400	4.19	100910
230	280	355	155	230	400	4.58	100911

Application:

This item is used to provide an inspection or cleaning access on dry or FU applications under negative pressure conditions (N1).

# Schiedel ICS25

## Inspec. Tee P1 Short

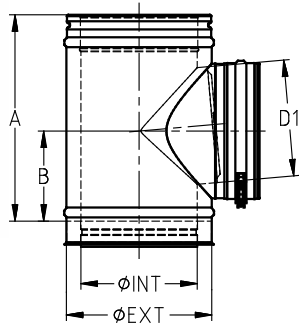

ØINT mm	ØEXT mm	A mm	B mm	D1 mm	Nominal length mm	Weight kg	Material
80	130	288	121	80	333	1.97	100893
100	150	288	121	100	333	2.27	100894
80	130	288	121	80	333	1.97	148403
100	150	288	121	100	333	2.27	148404
130	180	288	121	130	333	1.76	100895
150	200	305	130	150	350	2.21	100896
180	230	305	130	150	350	2.46	100897
200	250	355	155	200	400	4.19	100898
230	280	355	155	230	400	4.58	101304

**Application:**

This item is used to provide an inspection or cleaning access on Wet applications under positive pressure conditions (P1).

Inner Liners/Pipe 1000mm

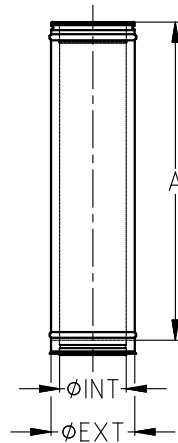

ØINT mm	ØEXT mm	A mm	Nominal length mm	Weight kg	Material
80	130	955	1000	3.99	100698
80	130	955	1000	3.99	116493
100	150	955	1000	4.73	100699
100	150	955	1000	4.73	117091
130	180	955	1000	5.84	100700
130	180	955	1000	5.84	117623
150	200	955	1000	6.58	100701
150	200	955	1000	6.58	117960
180	230	955	1000	7.69	100702
180	230	955	1000	7.69	118311
200	250	955	1000	8.43	100703
200	250	955	1000	8.43	118468
230	280	955	1000	9.56	100704
230	280	955	1000	9.56	118713
250	300	955	1000	10.28	100705
250	300	955	1000	10.28	113605
300	350	955	1000	12.08	100706
350	400	955	1000	13.96	100707
400	450	955	1000	15.81	100708
450	500	955	1000	19.1	100709
500	550	955	1000	21.1	100710
600	650	955	1000	25.09	100711
700	750	955	1000	29.07	100712

Application:

This item is the longest available pipe length in the ICS range. It is provided with a standard locking band. Suitable for use without any gaskets in negative pressure (N1) applications. By adding a lip seal gasket (See S000 and V000 at the bottom of this page) to the male end of the liner it can be used on positive pressure applications (P1). By adding a Pressure seal to the male end of the outer case, it can be converted for use on high positive pressure applications (H1 - See ICS5000)



Inner Liners/Pipe 500mm

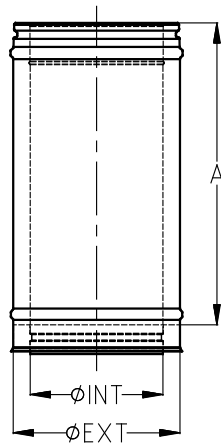

ØINT mm	ØEXT mm	A mm	Nominal length mm	Weight kg	Material
80	130	455	500	1.98	100684
80	130	455	500	1.98	113542
100	150	455	500	2.34	100685
100	150	455	500	2.34	114693
130	180	455	500	2.89	100686
130	180	455	500	2.89	115393
150	200	455	500	3.26	100687
150	200	455	500	3.26	115902
180	230	455	500	3.8	100688
180	230	455	500	3.8	116368
200	250	455	500	4.17	100689
200	250	455	500	4.17	116715
230	280	455	500	4.73	101288
230	280	455	500	4.73	117086
250	300	455	500	5.08	100690
250	300	455	500	5.08	117321
300	350	455	500	5.97	100691
350	400	455	500	6.9	100692
400	450	455	500	7.82	100693
450	500	455	500	9.42	100694
500	550	455	500	10.41	100695
600	650	455	500	12.38	100696
700	750	455	500	14.34	100697

Application:

This item is the medium pipe length in the ICS range. It is provided with a standard locking band. Suitable for use without any gaskets in negative pressure (N1) applications. By adding a lip seal gasket (See S000 and V000 at the bottom of this page) to the male end of the liner it can be used on positive pressure applications (P1). By adding a Pressure seal to the male end of the outer case, it can be converted for use on high positive pressure applications (H1 - See ICS5000)

# Schiedel ICS25

## Inner Liners/Pipe 250mm

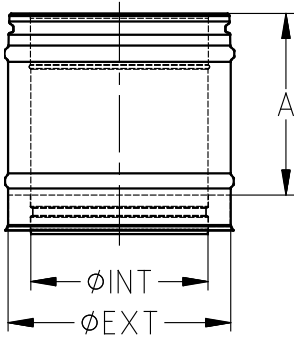

ØINT mm	ØEXT mm	A mm	Nominal length mm	Weight kg	Material
80	130	205	250	0.97	100670
80	130	205	250	0.97	111569
100	150	205	250	1.15	100671
100	150	205	250	1.15	111980
130	180	205	250	1.42	100672
130	180	205	250	1.42	112593
150	200	205	250	1.59	100673
150	200	205	250	1.59	112909
180	230	205	250	1.86	100674
180	230	205	250	1.86	113364
200	250	205	250	2.04	100675
200	250	205	250	2.04	114271
230	280	205	250	2.31	101287
230	280	205	250	2.31	114610
250	300	205	250	2.49	100676
250	300	205	250	2.49	114926
300	350	205	250	2.92	100677
350	400	205	250	3.37	100678
400	450	205	250	3.82	100679
450	500	205	250	4.59	100680
500	550	205	250	5.07	100681
600	650	205	250	6.01	100682
700	750	205	250	6.97	100683

**Application:**

This item is the second shortest pipe length in the ICS range. It is provided with a standard locking band. Suitable for use without any gaskets in negative pressure (N1) applications. By adding a lip seal gasket (See S000 and V000 at the bottom of this page) to the male end of the liner it can be used on positive pressure applications (P1). By adding a Pressure seal to the male end of the outer case, it can be converted for use on high positive pressure applications (H1 - See ICS5000)

# Schiedel ICS25

## Inner Liners/Pipe 200mm

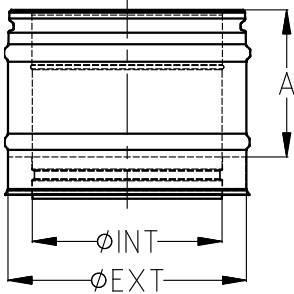

ØINT mm	ØEXT mm	A mm	Nominal length mm	Weight kg	Material
80	130	155	200	0.77	100656
80	130	155	200	0.77	111160
100	150	155	200	0.91	100657
100	150	155	200	0.91	111471
130	180	155	200	1.12	100658
130	180	155	200	1.12	111949
150	200	155	200	1.26	100659
150	200	155	200	1.26	112244
180	230	155	200	1.47	100660
180	230	155	200	1.47	112673
200	250	155	200	1.61	100661
200	250	155	200	1.61	112961
230	280	155	200	1.83	101286
230	280	155	200	1.83	113282
250	300	155	200	1.97	100662
250	300	155	200	1.97	113516
300	350	155	200	2.31	100663
350	400	155	200	2.67	100664
400	450	155	200	3.02	100665
450	500	155	200	4.79	100666
500	550	155	200	5.25	100667
600	650	155	200	6.59	100668
700	750	155	200	7.37	100669

**Application:**

This item is the shortest pipe length in the ICS range. It is provided with a standard locking band. Suitable for use without any gaskets in negative pressure (N1) applications. By adding a lip seal gasket (See S000 and V000 at the bottom of this page) to the male end of the liner it can be used on positive pressure applications (P1). By adding a Pressure seal to the male end of the outer case, it can be converted for use on high positive pressure applications (H1 - See ICS5000)

**Inner Liners/Pipe 195-250mm**

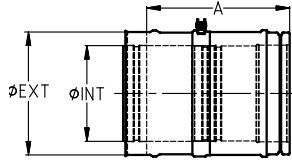

ØINT mm	ØEXT mm	A mm	Weight kg	Material
80	130	195-250	1.55	112821
80	130	195-250	1.55	148393
100	150	195-250	1.83	118924
100	150	195-250	1.83	148394
130	180	195-250	2.25	114523
150	200	195-250	2.53	114975
180	230	195-250	2.96	115450
200	250	195-250	3.24	115885
230	280	195-250	3.67	116270
250	300	195-250	3.94	116481
300	350	195-250	4.63	117047
350	400	195-250	5.35	117402
400	450	195-250	6.08	117775
450	500	195-250	6.78	118009
500	550	195-250	7.48	118196
600	650	195-250	8.88	118580
700	750	195-250	10.27	113599

**Application:**

This item is the shortest adjustable pipe length in the ICS range. It is provided with a standard locking band and a cover band to cover the joint in the middle of the pipe. Suitable for use without any gaskets in negative pressure (N1) applications. By adding 3 lip seal gasket (See S000 and V000 at the bottom of this page) to the male beads on the liner it can be used on positive pressure applications (P1). Adjustment is made by sliding the two halves of the pipe apart, removing insulation from the top half to suit, and then reassembling the pipes. Adjustable pipes are not load bearing and if used in the vertical must be used in conjunction with a wall support.

**Inner Liners/Pipe 270-375mm**

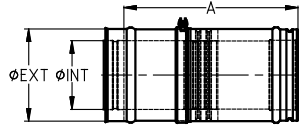

ØINT mm	ØEXT mm	A mm	Weight kg	Material
80	130	270-375	2.15	100713
80	130	270-375	2.15	148376
100	150	270-375	2.54	100714
100	150	270-375	2.54	148377
130	180	270-375	3.13	100715
150	200	270-375	3.51	100716
180	230	270-375	4.1	100717
200	250	270-375	4.49	100718
230	280	270-375	5.09	101289
250	300	270-375	5.47	100719
300	350	270-375	6.42	100720
350	400	270-375	7.42	100721
400	450	270-375	8.44	100722
450	500	270-375	9.41	100723
500	550	270-375	10.38	100724
600	650	270-375	12.32	100725
700	750	270-375	14.25	100726

**Application:**

This item is the medium adjustable pipe length in the ICS range. It is provided with a standard locking band and a cover band to cover the joint in the middle of the pipe. Suitable for use without any gaskets in negative pressure (N1) applications. By adding 3 lip seal gasket (See S000 and V000 at the bottom of this page) to the male beads on the liner it can be used on positive pressure applications (P1). Adjustment is made by sliding the two halves of the pipe apart, removing insulation from the top half to suit, and then reassembling the pipes. Adjustable pipes are not load bearing and if used in the vertical must be used in conjunction with a wall support.

# Schiedel ICS25

## Inner Liners/Pipe 375-585mm

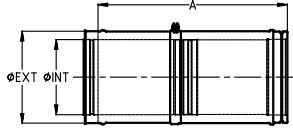

ØINT mm	ØEXT mm	A mm	Weight kg	Material
80	130	375-585	3.02	115682
100	150	375-585	3.57	116193
130	180	375-585	4.4	116882
150	200	375-585	4.94	117207
180	230	375-585	5.77	117556
200	250	375-585	6.31	117873
230	280	375-585	7.15	118141
250	300	375-585	7.69	118305
300	350	375-585	9.03	118639
350	400	375-585	10.43	113624
400	450	375-585	11.87	113731
450	500	375-585	13.23	113870
500	550	375-585	14.6	113941
600	650	375-585	17.32	114085
700	750	375-585	20.05	115486

**Application:**

This item is the longest adjustable pipe length in the ICS range. It is provided with a standard locking band and a cover band to cover the joint in the middle of the pipe. Suitable for use without any gaskets in negative pressure (N1) applications. By adding 3 lip seal gasket (See S000 and V000 at the bottom of this page) to the male beads on the liner it can be used on positive pressure applications (P1). Adjustment is made by sliding the two halves of the pipe apart, removing insulation from the top half to suit, and then reassembling the pipes. Adjustable pipes are not load bearing and if used in the vertical must be used in conjunction with a wall support.

**System elements measure pipe 1t**

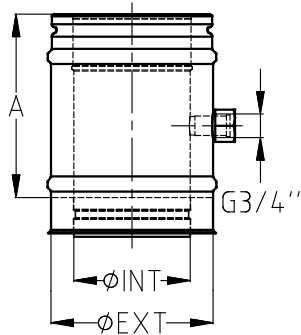

ØINT mm	ØEXT mm	A mm	Nominal length mm	Weight kg	Material
80	130	205	250	1.03	101140
80	130	205	250	1.03	148401
100	150	205	250	1.22	101141
100	150	205	250	1.22	148402
130	180	205	250	1.49	101142
150	200	205	250	1.68	101143
180	230	205	250	1.95	101144
200	250	205	250	2.14	101145
230	280	205	250	2.42	101343
250	300	205	250	2.6	101146
300	350	205	250	3.05	101147
350	400	205	250	3.52	101148
400	450	205	250	3.98	101149
450	500	205	250	4.69	101150
500	550	205	250	5.17	101151
600	650	205	250	6.12	101152
700	750	205	250	7.07	101153

**Application:**

This item is used to allow for the sampling of the flue gases where required. It is provided with a standard locking band.

## Schiedel ICS25

### Measuring pipe 3t.

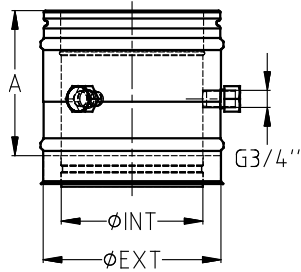

ØINT mm	ØEXT mm	A mm	Nominal length mm	Weight kg	Material
80	130	205	250	1.08	101344
100	150	205	250	1.28	101345
130	180	205	250	1.56	101346
150	200	205	250	1.76	101347
180	230	205	250	2.05	101348
200	250	205	250	2.24	101349
230	280	205	250	2.54	101350
250	300	205	250	2.73	101351
300	350	205	250	3.2	101352
350	400	205	250	3.69	101353
400	450	205	250	4.18	101354
450	500	205	250	4.92	101355
500	550	205	250	5.42	101356
600	650	205	250	6.42	101357
700	750	205	250	7.42	101358

#### Application:

This item is a requirement in the Slovakian market. It is used to allow for the sampling of the flue gases where required. It is provided with a standard locking band.



# Schiedel ICS25

## Meas.Solid\_Part.

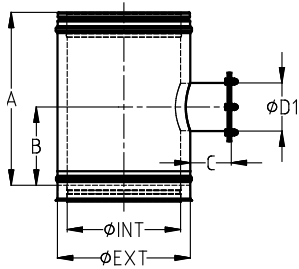

ØINT mm	ØEXT mm	A mm	B mm	C mm	D1 mm	Nominal length mm	Weight kg	Material
250	300	455	205	108	127	500	8.32	137926
300	350	455	205	108	127	500	9.54	137927
350	400	455	205	108	127	500	12.34	137928
400	450	455	205	108	127	500	13.6	137929
450	500	455	205	108	127	500	14.83	137930
500	550	455	205	108	127	500	16.08	137931
600	650	455	205	108	127	500	19.37	137932
700	750	455	205	108	127	500	21.98	137933

Vertical\_drain

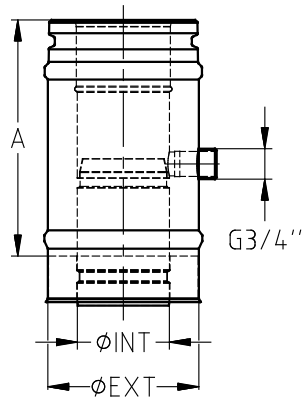

ØINT mm	ØEXT mm	A mm	Nominal length mm	Weight kg	Material
80	130	205	250	1.03	101154
80	130	205	250	1.03	148405
100	150	205	250	1.22	101155
100	150	205	250	1.22	148406
130	180	205	250	1.49	101156
150	200	205	250	1.68	101157
180	230	205	250	1.95	101158
200	250	205	250	2.14	101159
230	280	205	250	2.42	101359
250	300	205	250	2.6	101160
300	350	205	250	3.05	101161
350	400	205	250	3.05	101162
400	450	205	250	3.52	101163
450	500	205	250	4.69	101164
500	550	205	250	5.17	101165
600	650	205	250	6.12	101166
700	750	205	250	7.07	101167

Application:

This item may be used in the horizontal connecting flue pipe or in the vertical chimney and is used to catch and drain off excess rainwater and/or condensates. It is provided with a standard locking band.

# Schiedel ICS25

## Inspection Pipe

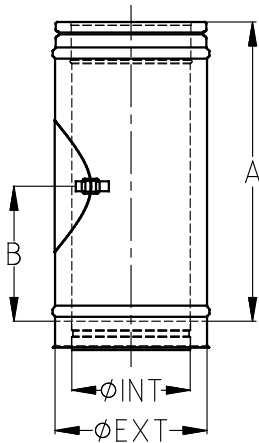

ØINT mm	ØEXT mm	A mm	B mm	Nominal length mm	Weight kg	Material
130	180	455	205	500	2.89	115391
150	200	455	205	500	3.26	115905
180	230	455	205	500	3.8	116364
200	250	455	205	500	4.17	116717
230	280	455	205	500	4.63	117046
250	300	455	205	500	5.09	117323
300	350	455	205	500	5.97	117693

**Application:**

This item may be used as an aesthetic alternative to an inspection tee on dry negative pressure applications. It is provided with a standard locking band.

## Smo.samp.tee

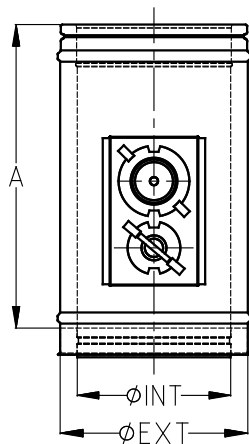

ØINT mm	ØEXT mm	A mm	Nominal length mm	Weight kg	Material
100	150	455	500	2.58	115775
130	180	455	500	3.18	116268
150	200	455	500	3.58	116608
180	230	455	500	4.18	117033
200	250	455	500	4.59	117206
230	280	455	500	5.2	117476
250	300	455	500	5.59	117642
300	350	455	500	6.57	118008
350	400	455	500	7.67	118334
400	450	455	500	8.76	118553
450	500	455	500	9.86	118718
500	550	455	500	10.95	113632
600	650	455	500	13.14	113792
700	750	455	500	15.33	113928

**Application:**

This item is a requirement of the Italian chimney market only. It is used together with the standard Nitidor Smoke sampling elements as required by the Italian Chimney norms on dry negative pressure applications. It is provided with a standard locking band.

# Schiedel ICS25

## 90° tee long

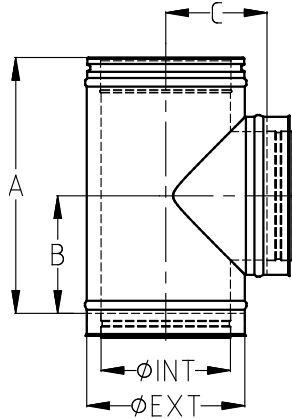

ØINT mm	ØEXT mm	A mm	B mm	C mm	W1 °	Nominal length mm	Weight kg	Material
80	130	288	126	105	90	333	1.63	100879
100	150	288	126	115	90	333	1.95	100880
130	180	455	209	130	90	500	3.42	100881
130	180	455	209	130	90	500	3.42	116107
150	200	455	209	140	90	500	3.88	100882
150	200	455	209	140	90	500	3.88	116448
180	230	455	209	155	90	500	4.57	100883
180	230	455	209	155	90	500	4.57	117025
200	250	455	209	165	90	500	5.04	100884
230	280	455	209	180	90	500	6.04	101303
250	300	455	209	190	90	500	6.56	100885
250	300	455	209	190	90	500	6.56	117953
300	350	480	222	205	90	525	7.9	100886
350	400	530	247	240	90	575	10.39	100887
400	450	605	285	280	90	650	13.36	100888
450	500	655	310	305	90	700	15.51	100889
500	550	705	335	330	90	750	18.7	100890
600	650	805	385	380	90	850	23.5	100891
700	750	905	435	430	90	950	31.44	100892

**Application:**

This item is used to connect from the connecting flue pipe to the vertical chimney.

Tee\_short

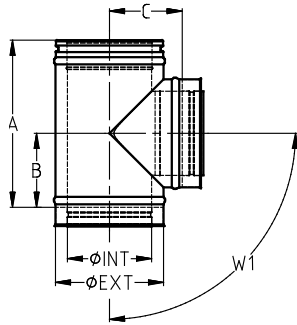

ØINT mm	ØEXT mm	A mm	B mm	C mm	W1 °	Nominal length	Weight kg	Material
130	180	306	132	130	90	351	2.3	114595
130	180	306	132	130	90	351	2.3	112880
150	200	326	142	140	90	371	2.78	115232
150	200	326	142	140	90	371	2.78	113386
180	230	355	156	155	90	400	3.56	116186
180	230	355	156	155	90	400	3.56	114584
200	250	375	166	165	90	420	4.15	120547
200	250	375	166	165	90	420	4.15	115231
230	280	407	181	180	90	452	5.4	117415
230	280	407	181	180	90	452	5.4	116187
250	300	427	191	190	90	472	6.15	117813
250	300	427	191	190	90	472	6.15	116706

Application:

This item is used to connect from the connecting flue pipe to the vertical chimney.

# Schiedel ICS25

## Flue connection tee 85°

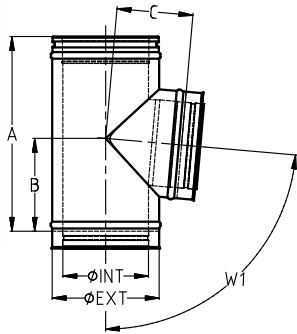

ØINT mm	ØEXT mm	A mm	B mm	C mm	W1 °	Nominal length mm	Weight kg	Material
80	130	291	132	112	85	336	1.63	100865
100	150	291	132	123	85	336	1.95	100866
130	180	456	215	139	85	501	3.42	100867
150	200	456	216	150	85	501	3.88	100868
180	230	455	216	167	85	500	4.57	100869
200	250	455	217	178	85	500	5.04	100870
230	280	455	218	215	85	500	6.04	101302
250	300	455	220	220	85	500	6.56	100871
300	350	490	245	234	85	535	7.9	100872
350	400	540	273	270	85	585	10.39	100873
400	450	605	304	305	85	650	12.81	100874
450	500	655	332	330	85	700	15.77	100875
500	550	705	359	355	85	750	19.01	100876
600	650	805	414	415	85	850	23.94	100877
700	750	905	469	470	85	950	32.02	100878

### Application:

This item is used in combination with a 95 degree elbow or 95 degree Inspection elbow to connect from a connecting flue pipe to the vertical chimney. It should be used on wet positive pressure applications (T200 P1) to provide for the smooth drain down of any condensates in the system to a suitable drain off point before reaching the appliance (e.g ICS25 250mm Pipe with Drain or Prima Plus Condensate Separator)

# Schiedel ICS25

## Tee with rear inspection opening N1 90°

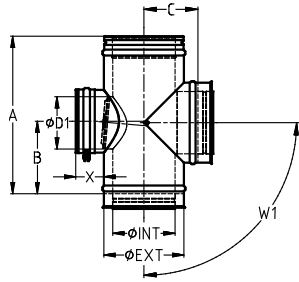

ØINT mm	ØEXT mm	A mm	B mm	C mm	D1 mm	W1 °	X mm	Nominal length mm	Weight kg	Material
130	180	455	206	130	130	90	64	500	3.83	101308
150	200	455	206	140	150	90	64	500	4.34	101309
180	230	455	206	155	150	90	64	500	5.12	101310
200	250	455	206	165	150	90	64	500	5.64	101311
230	280	455	206	180	150	90	64	500	6.4	101312
250	300	455	206	190	150	90	64	500	7.34	101313
300	350	485	228	215	200	90	64	530	7.9	101314

**Application:**

This item is used to provide an inspection or cleaning access on a 90 degree tee. It is used where space would not allow the use of a standard inspection tee below the 90 degree tee.

## Tee with rear inspection opening P1 90°

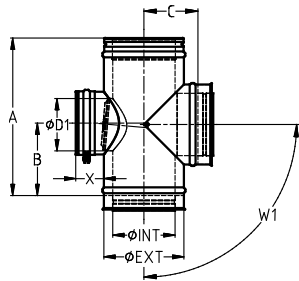

ØINT mm	ØEXT mm	A mm	B mm	C mm	D1 mm	W1 °	X mm	Nominal length mm	Weight kg	Material
130	180	455	206	130	130	90	64	500	3.83	100932
150	200	455	206	140	150	90	64	500	4.34	100933
180	230	455	206	155	150	90	64	500	5.12	100934
200	250	455	206	165	150	90	64	500	5.64	100935
230	280	455	206	180	150	90	64	500	6.4	101315
250	300	455	206	190	150	90	64	500	7.34	100936
300	350	485	228	215	200	90	64	530	7.9	100937

**Application:**

This item is used to provide an inspection or cleaning access on a 90 degree tee. It is used where space would not allow the use of a standard inspection tee below the 90 degree tee.

# Schiedel ICS25

## Tee 90° with rear Inspection

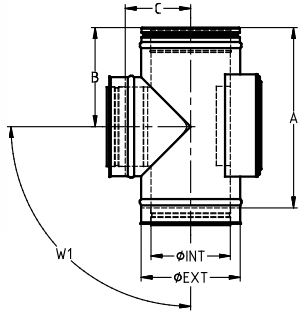

ØINT mm	ØEXT mm	A mm	B mm	C mm	W1 °	Nominal length mm	Weight kg	Material
130	180	455	250	130	90	500	3.66	104448
150	200	455	250	140	90	500	4.29	104449
180	230	455	250	155	90	500	5.48	104450
200	250	455	250	165	90	500	6.31	104451
250	300	455	250	190	90	500	8.76	104452
300	350	455	250	215	90	500	10.15	104453

### Application:

This item is used to provide a rectangular inspection or cleaning access on a 90 degree tee. It is used where space would not allow the use of a standard inspection tee below the 90 degree tee.

## Inspection tee patch

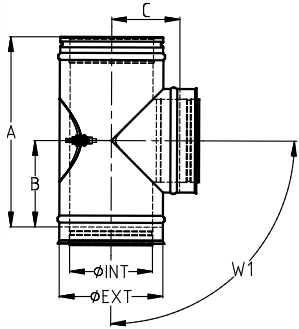

ØINT mm	ØEXT mm	A mm	B mm	C mm	W1 °	Nominal length mm	Weight kg	Material
130	180	455	205	130	90	500	3.4	116056
150	200	455	205	140	90	500	3.83	116383
180	230	455	205	155	90	500	4.89	117184
200	250	455	205	165	90	500	5.4	117411
230	280	455	205	180	90	500	6.42	117901
250	300	455	205	190	90	500	7.33	118174
300	350	485	220	215	90	530	9.34	118670

### Application:

This item is used to provide an inspection or cleaning access on a 90 degree tee. It is used where space would not allow the use of a standard inspection tee below the 90 degree tee.



## Schiedel ICS25

### Tee blind br.

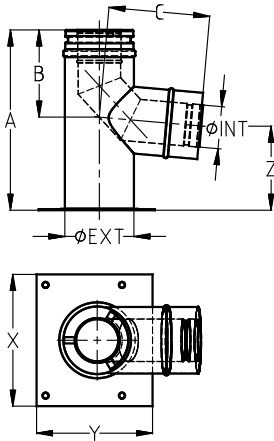

ØINT mm	ØEXT mm	A mm	B mm	C mm	X mm	Nominal length mm	Weight kg	Material
80	130	340	164	207	250	340	2.03	104446
100	150	340	164	207	270	340	2.39	104447
130	180	340	164	207	300	340	3	115482

**Application:**

This item is used in combination with a pair of Side Plates or Cantilever Supports. Air is brought into the boiler through the plate, and then standard Insulated ICS25 components are used in the vertical chimney.

### Flue connection ( RA ) Tee br.60

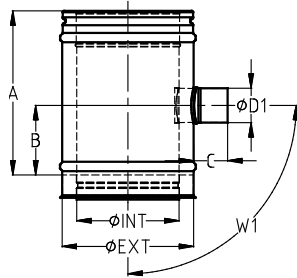

ØINT mm	ØEXT mm	A mm	B mm	C mm	D1 mm	W1 °	Nominal length mm	Weight kg	Material
80	130	285	124	60	60	90	330	1.85	113283
100	150	285	124	60	60	90	330	1.91	113430
130	180	285	124	60	60	90	330	2.07	114307
150	200	285	124	60	60	90	330	2.32	114613
180	230	285	124	60	60	90	330	2.65	115116
200	250	285	124	60	60	90	330	2.9	115432
230	280	285	124	60	60	90	330	3.22	115876
250	300	285	124	60	60	90	330	3.51	123937
300	350	285	124	60	60	90	330	4.12	116685
350	400	285	124	60	60	90	330	4.69	117065

**Application:**

This item is used to connect 60mm SW connecting flue pipes from 'C' type boilers to the main chimney where more than one boiler is being connected. Example MFH.

## Schiedel ICS25

### Flue connection ( RA ) Tee br.80

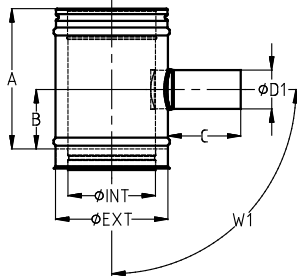

ØINT mm	ØEXT mm	A mm	B mm	C mm	D1 mm	W1 °	Nominal length mm	Weight kg	Material
80	130	285	124	150	80	90	330	1.85	120548
100	150	285	124	150	80	90	330	1.91	113423
130	180	285	124	150	80	90	330	2.07	114303
150	200	285	124	150	80	90	330	2.31	114612
180	230	285	124	150	80	90	330	2.65	115108
200	250	285	124	150	80	90	330	2.9	115417
230	280	285	124	150	80	90	330	3.22	115866
250	300	285	124	150	80	90	330	3.51	116156
300	350	285	124	150	80	90	330	4.12	116679
350	400	285	124	150	80	90	330	4.69	117063

#### Application:

This item is used to connect 80mm SW connecting flue pipes from 'C' type boilers to the main chimney where more than one boiler is being connected. Example MFH.

### Drain tee

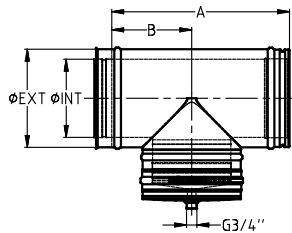

ØINT mm	ØEXT mm	A mm	B mm	Nominal length mm	Weight kg	Material
130	180	455	209	500	2.78	133796
150	200	455	209	500	3.29	133797
180	230	455	209	500	3.68	133798
200	250	455	209	500	4.71	133799
230	280	455	209	500	5.15	133800
250	300	455	209	500	6.88	133801
300	350	455	209	500	7.73	133802

## Schiedel ICS25

### Flue connection ( RA ) 45°

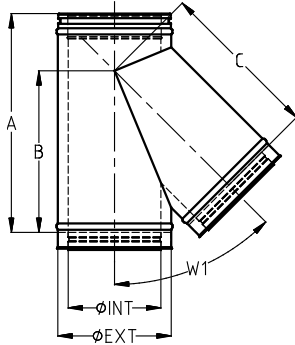

ØINT mm	ØEXT mm	A mm	B mm	C mm	W1 °	Nominal length mm	Weight kg	Material
80	130	330	218	219	45	375	1.85	100851
80	130	330	218	219	45	375	1.85	113314
100	150	355	246	245	45	400	2.47	100852
100	150	355	246	245	45	400	2.47	114914
130	180	455	328	328	45	500	4.11	100853
130	180	455	328	328	45	500	4.11	116671
150	200	455	329	328	45	500	4.63	100854
150	200	455	329	328	45	500	4.63	117052
180	230	455	322	325	45	500	5.37	100855
180	230	455	322	325	45	500	5.37	117406
200	250	530	378	376	45	575	6.8	100856
230	280	530	393	390	45	575	7.79	101301
230	280	530	393	390	45	575	7.79	118345
250	300	560	413	410	45	605	8.61	100857
250	300	560	413	410	45	605	8.61	118527
300	350	623	472	469	45	668	11.53	100858
350	400	697	530	530	45	742	14.78	100859
400	450	815	615	615	45	860	19.52	100860
450	500	885	675	675	45	930	21.49	100861
500	550	955	735	735	45	1000	26.09	100862
600	650	1100	855	855	45	1145	36.86	100863
700	750	1245	980	980	45	1290	48.94	100864

**Application:**

This item is used in combination with a 45 degree elbow to connect from the connecting flue pipe to the vertical chimney. It provides the least resistance to the flow of the flue gases.

**System elements Locking plug**

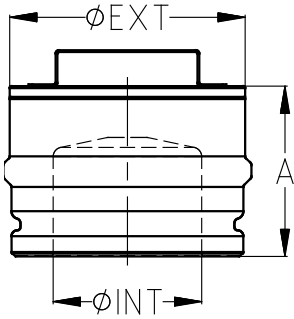

ØINT mm	ØEXT mm	A mm	Weight kg	Material
80	130	95	1.01	101104
80	130	95	1.01	148395
100	150	95	1.35	101105
100	150	95	1.35	148396
130	180	95	1.7	101106
150	200	95	1.94	101107
180	230	95	2.33	101108
200	250	95	2.6	101109
230	280	95	3.1	101342
250	300	95	3.36	101110
300	350	95	4.09	101111
350	400	95	4.7	101112
400	450	95	5.08	101113
450	500	95	5.24	101114
500	550	95	5.58	101115
600	650	95	6.52	101116
700	750	95	8.23	101117

**Application:**

This item is used together with a tee on dry negative pressure applications to provide inspection or cleaning access.

## Schiedel ICS25

### Tee plug with Draught stabil.

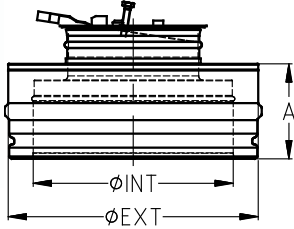

ØINT mm	ØEXT mm	A mm	Weight kg	Material
130	180	95	0.71	101204
150	200	95	0.81	101205
180	230	95	0.95	101206
200	250	95	1.04	101207
230	280	95	1.19	101208
250	300	95	1.28	101209
300	350	95	1.51	101210
350	400	95	1.77	101211

**Application:**

This item is used together with a 90 degree tee in order to allow regulation of draught in the system.

# Schiedel ICS25

## Adaptor ICS PPL

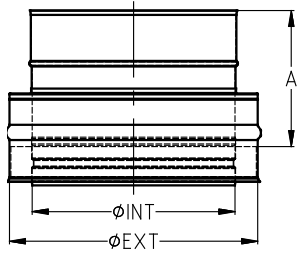

ØINT mm	ØEXT mm	A mm	Nominal length mm	Weight kg	Material
80	130	155	200	0.47	101190
80	130	155	200	0.47	148397
100	150	155	200	0.57	101191
100	150	155	200	0.57	148398
130	180	155	200	0.71	101192
150	200	155	200	0.81	101193
180	230	155	200	0.95	101194
200	250	155	200	1.04	101195
230	280	155	200	1.19	101361
250	300	155	200	1.28	101196
300	350	155	200	1.51	101197
350	400	155	200	1.72	101198
400	450	155	200	1.88	101199
450	500	155	200	2.89	101200
500	550	155	200	3.19	101201
600	650	155	200	3.78	101202
700	750	155	200	4.37	101203

**Application:**

This item is used to connect from ICS25 to the Prima Plus SW product range. Example where ICS25 used as a connecting flue pipe connects to Prima Plus used to line an existing chimney

# Schiedel ICS25

## Adaptor PPL ICS

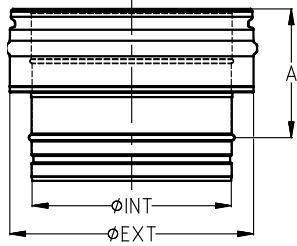

ØINT mm	ØEXT mm	A mm	Nominal length mm	Weight kg	Material
80	130	150	195	0.47	101176
80	130	150	195	0.47	148399
100	150	150	195	0.57	101177
100	150	150	195	0.57	148400
130	180	150	195	0.71	101178
150	200	150	195	0.81	101179
180	230	150	195	0.95	101180
200	250	150	195	1.04	101181
230	280	150	195	1.19	101360
250	300	150	195	1.28	101182
300	350	150	195	1.51	101183
350	400	150	195	1.77	101184
400	450	150	195	2.05	101185
450	500	150	195	3.04	101186
500	550	150	195	3.35	101187
600	650	150	195	3.97	101188
700	750	150	195	4.59	101189

**Application:**

This adaptor provides the standard connection from the Prima Plus SW system to ICS25

# Schiedel ICS25

## Adaptor ICS Flex

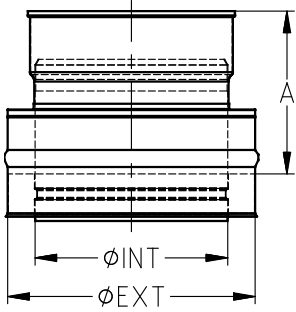

ØINT mm	ØEXT mm	A mm	Nominal length mm	Weight kg	Material
130	180	155	200	0.71	111031
150	200	155	200	0.81	111281
180	230	155	200	0.95	111535
200	250	155	200	1.04	111743
230	280	155	200	1.19	112043
250	300	155	200	1.28	112255
300	350	155	200	1.51	112770

**Application:**

This item is used to connect from ICS25 to the Tecnoflex product range. Example where ICS25 used as a connecting flue pipe connects to Tecnoflex used to line an existing chimney



# Schiedel ICS25

## Adaptor reducer

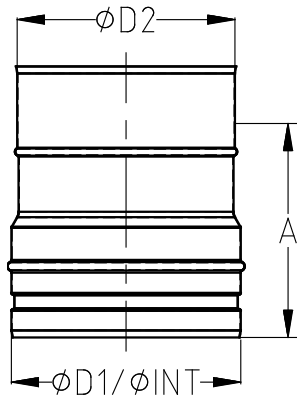

$\phi INT$ mm	A mm	D1 mm	D2 mm	Nominal length mm	Weight kg	Material
113	150	113	100	200	0.3	101752
120	150	120	100	200	0.33	101753
120	150	120	113	200	0.35	101754
130	150	130	100	200	0.41	101755
130	150	130	113	200	0.34	101756
130	150	130	120	200	0.36	101757
150	150	150	120	200	0.39	101758
150	150	150	130	200	0.4	101759
150	150	150	140	200	0.44	101760
160	150	160	130	200	0.46	101761
160	150	160	140	200	0.48	101762
160	150	160	150	200	0.5	101763
180	150	180	130	200	0.51	101764
180	150	180	140	200	0.56	101765
180	150	180	150	200	0.59	101766
180	150	180	160	200	0.53	101767
200	150	200	150	200	0.59	101768
200	150	200	160	200	0.57	101769
200	150	200	180	200	0.55	101770
230	150	230	180	200	0.59	101773
230	150	230	200	200	0.61	101774
250	150	250	200	200	0.75	101776
250	150	250	230	200	0.7	101777
300	150	300	250	200	0.91	101778

# Schiedel ICS25

## Adaptor Increaser

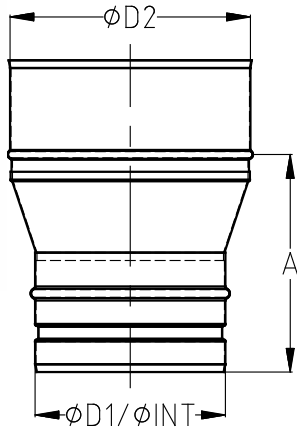

ØINT mm	A mm	D1 mm	D2 mm	Nominal length mm	Weight kg	Material
80	150	80	100	200	0.33	101779
80	150	80	113	200	0.35	101780
80	150	80	120	200	0.3	101781
80	150	80	130	200	0.4	101782
100	150	100	113	200	0.41	101783
100	150	100	120	200	0.41	101784
100	150	100	130	200	0.42	101785
100	150	100	140	200	0.33	101786
100	150	100	150	200	0.34	101787
113	150	113	120	200	0.38	101788
113	150	113	130	200	0.4	101789
113	150	113	140	200	0.35	101790
113	150	113	150	200	0.39	101791
120	150	120	130	200	0.39	101792
120	150	120	140	200	0.39	101793
120	150	120	150	200	0.4	101794
130	150	130	140	200	0.5	101795
130	150	130	150	200	0.51	101796
130	150	130	160	200	0.5	101797
130	150	130	180	200	0.59	101798
150	150	150	160	200	0.58	101799
150	150	150	180	200	0.53	101800
150	150	150	200	200	0.54	101801
160	150	160	180	200	0.55	101802
160	150	160	200	200	0.68	101803
180	150	180	200	200	0.73	101804
180	150	180	230	200	0.61	101805
180	150	180	250	200	0.75	101806
200	150	200	230	200	0.7	101807
200	150	200	250	200	0.91	101808
230	150	230	250	200	1.12	101810
250	150	250	300	200	0	101811
300	150	300	350	200	0	101812

# Schiedel ICS25

## Adaptor ICS

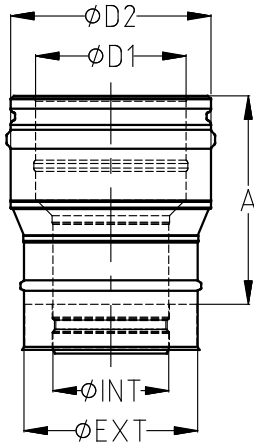

ØINT mm	ØEXT mm	A mm	D1 mm	D2 mm	Nominal length mm	Weight kg	Material
80	130	180	100	150	225	1.11	101890
80	130	180	100	150	225	1.11	148386
100	150	180	130	180	225	1.37	101891
100	150	180	130	180	225	1.37	148387
130	180	180	150	200	225	1.59	101892
150	200	180	180	230	225	1.87	101893
180	230	180	200	250	225	2.04	101894
200	250	180	230	280	225	2.34	101895
230	280	180	250	300	225	2.49	101896
250	300	190	300	350	235	3.06	101897
300	350	190	350	400	235	3.55	101898
350	400	190	400	450	235	4.05	101899
400	450	190	450	500	235	4.54	101900
450	500	190	500	550	235	5.03	101901

**Application:**

This insulated item is used to increase from one diameter to the next largest diameter of ICS25

# Schiedel ICS25

## Adaptor App. Conn. Econ

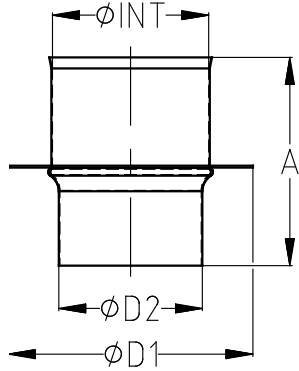

ØINT mm	A mm	D1 mm	D2 mm	Weight kg	Material
80	110	128	75	0.22	109926
80	110	128	75	0.22	148382
100	110	148	95	0.28	110046
100	110	148	95	0.28	148383
130	110	178	125	0.39	110293
150	110	198	145	0.47	110509
180	110	228	175	0.59	110771
200	110	248	195	0.68	110921
230	110	278	225	0.83	111325
250	110	298	245	0.93	111519
300	110	348	295	1.21	112111

**Application:**

This is an uninsulated item, which connects directly into the appliance spigot. The steel ring blocks off the insulation of the next ICS component.

# Schiedel ICS25

## Adaptor App. Conn.

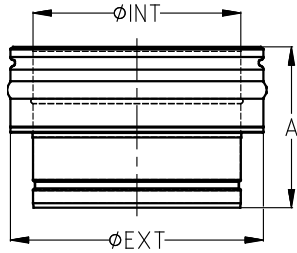

ØINT mm	ØEXT mm	A mm	Weight kg	Material
80	130	178	0.43	110466
80	130	178	0.43	148384
100	150	178	0.51	110688
100	150	178	0.51	148385
130	180	178	0.64	110916
150	200	178	0.72	111158
180	230	178	0.85	111468
200	250	178	0.94	111593
230	280	178	1.07	111960
250	300	178	1.15	112147
300	350	178	1.36	112636
350	400	178	1.58	112881
400	450	178	1.76	113163
450	500	178	1.94	129678
500	550	178	2.15	114400
600	650	178	2.52	114960
700	750	178	2.87	115379

**Application:**

This is a fully insulated item, which has a tapered liner and is used to connect directly into the appliance spigot.

# Schiedel ICS25

## Adaptor sleeve ad sw ics

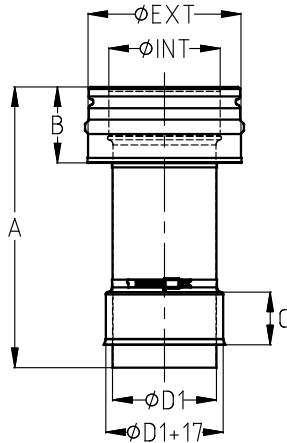

ØINT mm	ØEXT mm	A mm	B mm	C mm	D1 mm	Weight kg	Material
100	150	325	92	55	93	1.2	101168
130	180	325	92	55	123	1.3	101169
130	200	325	92	55	123	1.41	101170
150	200	325	92	55	143	1.49	101171
150	230	325	92	55	143	1.67	101172
180	230	325	92	55	173	1.81	101173
180	250	325	92	55	173	1.92	101174
200	250	325	92	55	193	2.03	101175
100	180	325	92	55	93	1.25	104479
120	180	325	92	55	113	1.33	104480
150	180	325	92	55	143	1.39	104481
120	200	325	92	55	113	1.36	104482
160	200	325	92	55	153	1.55	104483
180	200	325	92	55	173	1.69	104484
160	230	325	92	55	153	1.7	104485
200	230	325	92	55	193	1.93	104486
80	180	325	92	55	73	1.07	132178
130	230	325	92	55	123	1.54	132179
150	250	325	92	55	143	1.73	132180
160	250	325	92	55	153	1.76	132181
250	300	325	92	55	243	2.38	132182
250	350	325	92	55	293	2.83	132183

**Application:**

This item is used to provide a connector from non-Schiedel connecting flue pipe, such as black stove pipe to ICS25

# Schiedel ICS25

## Sleeved ad

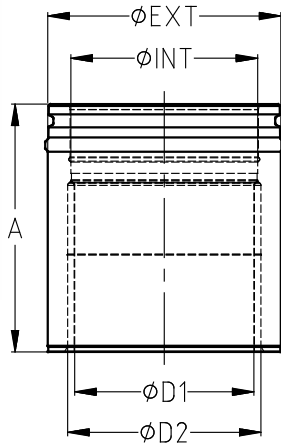

ØINT mm	ØEXT mm	A mm	D1 mm	D2 mm	Weight kg	Material
130	180	267	123	139	2.07	114302
150	200	267	143	159	2.29	114561
200	250	267	193	209	2.84	115357
250	300	267	243	259	3.39	116031
300	350	267	293	309	3.94	116483

## Adaptor adj.sleev.

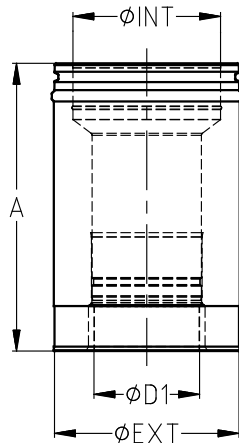

ØINT mm	ØEXT mm	D1 mm	A mm	Weight kg	Material
130	180	123	390-475	2.78	104487
150/130	200	123	390-475	3.15	104488
150/150	200	143	390-475	3.15	104489
180/150	230	143	390-475	3.75	104491
180/180	230	173	390-475	3.7	104492
200/150	250	143	390-475	4.35	104493
200/180	250	173	390-475	4.13	104494
200/200	250	193	390-475	4.07	104495

### Application:

This item is used to provide a connector from non-Schiedel connecting flue pipe, such as black stove pipe to ICS25. It allows for adjustment in length between 390mm and 475mm Available only in diameters 130mm - 200mm

# Schiedel ICS25

## Bend 15°

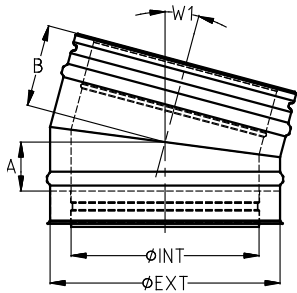

ØINT mm	ØEXT mm	A mm	B mm	W1 °	Weight kg	Material
80	130	55	95	15	0.74	100727
80	130	55	95	15	0.74	111089
100	150	55	95	15	0.88	100728
100	150	55	95	15	0.88	111396
130	180	55	95	15	1.08	100729
130	180	55	95	15	1.08	111830
150	200	55	95	15	1.22	100730
150	200	55	95	15	1.22	112167
180	230	60	100	15	1.43	100731
180	230	60	100	15	1.43	112623
200	250	60	100	15	1.57	100732
200	250	60	100	15	1.57	112854
230	280	60	100	15	1.78	101290
230	280	60	100	15	1.78	113177
250	300	65	105	15	1.91	100733
250	300	65	105	15	1.91	113431
300	350	65	105	15	2.25	100734
350	400	70	110	15	2.87	100735
400	450	87	131	15	3.25	100736
450	500	92	136	15	5.55	100737
500	550	97	141	15	6.13	100738
600	650	107	151	15	7.54	100739
700	750	119	163	15	9.41	100740

Application:

This item is used in pairs to provide an offset. It is supplied together with one standard locking band.



# Schiedel ICS25

## Bend 30°

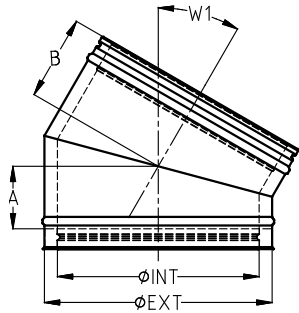

ØINT mm	ØEXT mm	A mm	B mm	W1 °	Weight kg	Material
80	130	55	95	30	0.74	100741
80	130	55	95	30	0.74	111091
100	150	60	100	30	0.88	100742
100	150	60	100	30	0.88	111398
130	180	67	107	30	1.08	100743
130	180	67	107	30	1.08	111793
150	200	70	110	30	1.22	100744
150	200	70	110	30	1.22	112174
180	230	75	115	30	1.8	100745
180	230	75	115	30	1.8	113242
200	250	80	120	30	1.98	100746
200	250	80	120	30	1.98	113546
230	280	80	120	30	2.25	101291
230	280	80	120	30	2.25	114518
250	300	85	125	30	2.42	100747
250	300	85	125	30	2.42	114815
300	350	90	130	30	2.84	100748
350	400	100	140	30	4.42	100749
400	450	122	166	30	5	100750
450	500	127	171	30	6.71	100751
500	550	132	176	30	7.63	100752
600	650	147	191	30	9.83	100753
700	750	162	206	30	11.98	100754

Application:

This item is used in pairs to provide an offset. It is supplied together with one standard locking band.

**Bend 45°**

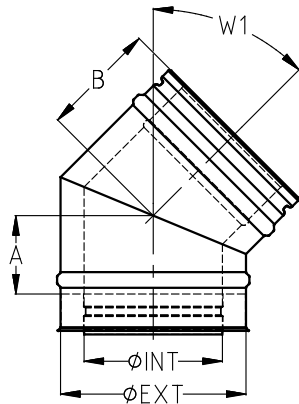

ØINT mm	ØEXT mm	A mm	B mm	W1 mm	Weight kg	Material
80	130	70	110	45	0.93	100755
80	130	70	110	45	0.93	111522
100	150	75	115	45	1.11	100756
100	150	75	115	45	1.11	111937
130	180	80	120	45	1.37	100757
130	180	80	120	45	1.37	112487
150	200	85	125	45	1.54	100758
150	200	85	125	45	1.54	112806
180	230	90	130	45	1.8	100759
180	230	90	130	45	1.8	113246
200	250	95	135	45	2.15	100760
200	250	95	135	45	2.15	114388
230	280	105	145	45	2.53	101292
230	280	105	145	45	2.53	114968
250	300	105	145	45	2.82	100761
250	300	105	145	45	2.82	111303
300	350	115	155	45	3.83	100762
350	400	130	170	45	4.42	100763
400	450	152	196	45	5	100764
450	500	162	206	45	7.88	100765
500	550	172	216	45	9.13	100766
600	650	192	236	45	11.87	100767
700	750	212	256	45	14.92	100768

**Application:**

This item is used in pairs to provide an offset. It is supplied together with one standard locking band. It can also be used in combination with a 135 degree Tee to provide a connection from a horizontal connecting flue pipe to a vertical chimney system.

# Schiedel ICS25

## Bend 85°

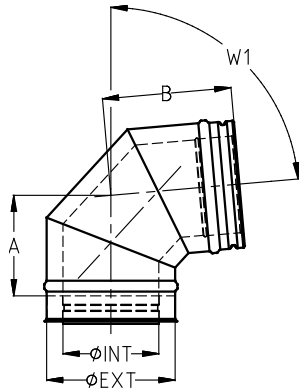

ØINT mm	ØEXT mm	A mm	B mm	W1 °	Weight kg	Material
80	130	126	170	85	1.2	100769
100	150	133	177	85	1.5	100770
100	150	133	177	85	1.5	112760
130	180	149	193	85	2	100771
130	180	149	193	85	2	114178
150	200	158	202	85	2.38	100772
150	200	158	202	85	2.38	114763
180	230	173	217	85	3.07	100773
180	230	173	217	85	3.07	115708
200	250	185	229	85	3.39	100774
200	250	185	229	85	3.39	116034
230	280	199	243	85	3.86	101293
230	280	199	243	85	3.86	116431
250	300	208	252	85	4.55	100775
250	300	208	252	85	4.55	117010
300	350	232	276	85	5.84	100776
350	400	258	302	85	7.33	100777
350	400	258	302	85	7.33	131155
400	450	275	315	85	9.7	100778
450	500	373	411	85	11.61	100779
500	550	398	436	85	13.6	100780
600	650	447	485	85	18	100781
700	750	496	534	85	22.98	100782

**Application:**

This item is used to provide a change of direction on a connecting flue pipe. It is used in combination with a 95 degree tee.

# Schiedel ICS25

## Bend 90°

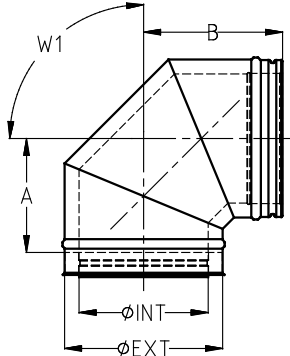

ØINT mm	ØEXT mm	A mm	B mm	W1 °	Weight kg	Material
80	130	128	172	90	1.2	100810
80	130	128	172	90	1.2	112105
100	150	136	180	90	1.5	100811
100	150	136	180	90	1.5	112748
130	180	152	196	90	2	100812
130	180	152	196	90	2	114190
150	200	161	205	90	2.38	100813
150	200	161	205	90	2.38	114761
180	230	176	220	90	3.07	100814
180	230	176	220	90	3.07	115710
200	250	188	232	90	3.39	100815
200	250	188	232	90	3.39	116033
230	280	204	248	90	3.86	101297
230	280	204	248	90	3.86	116429
250	300	212	256	90	4.55	100816
250	300	212	256	90	4.55	117015
300	350	237	281	90	5.84	100817
350	400	264	308	90	7.33	100818
400	450	290	330	90	9.8	100819
450	500	396	434	90	11.61	100820
500	550	421	459	90	13.6	100821
600	650	471	509	90	18	100822
700	750	522	560	90	22.98	100823

Application:

This item is used to provide a change of direction on a connecting flue pipe.

# Schiedel ICS25

## Inspect. Bend 85° N1

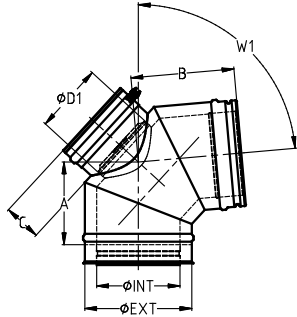

ØINT mm	ØEXT mm	A mm	B mm	C mm	D1 mm	W1 °	Weight kg	Material
80	130	153	197	64	80	85	1.61	101294
100	150	151	195	64	100	85	2.02	101295
130	180	163	207	64	130	85	2.68	100797
150	200	182	226	64	150	85	3.05	100798
180	230	179	223	64	150	85	3.68	100799
200	250	185	229	64	150	85	3.98	100800
230	280	199	243	64	150	85	3.86	100801
250	300	208	252	64	150	85	5.12	100802
300	350	232	276	64	200	85	6.74	100803
350	400	258	302	64	200	85	8.18	100804
400	450	275	315	64	250	85	10.2	100805
450	500	441	479	64	250	85	12.78	100806
500	550	452	490	64	250	85	14.94	100807
600	650	474	512	64	250	85	19.5	100808
700	750	496	534	64	250	85	24.9	100809

**Application:**

This item is used to provide a change of direction on a connecting flue pipe on dry or wet negative pressure applications. The locking plug on the middle section may be removed to allow inspection and cleaning access

# Schiedel ICS25

## Inspect. Bend 85° P1

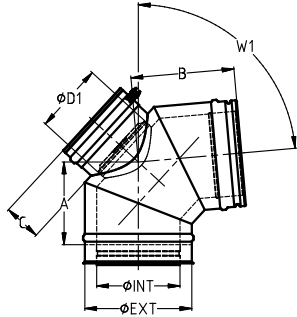

ØINT mm	ØEXT mm	A mm	B mm	C mm	D1 mm	W1 °	Weight kg	Material
80	130	153	197	64	80	85	1.61	100783
100	150	151	195	64	100	85	2.02	100784
130	180	163	207	64	130	85	2.68	100785
150	200	182	226	64	150	85	3.05	100786
180	230	179	223	64	150	85	3.68	100787
200	250	185	229	64	150	85	3.98	100788
230	280	199	243	64	150	85	3.86	101296
250	300	208	252	64	150	85	5.12	100789
300	350	232	276	64	200	85	6.74	100790
350	400	258	302	64	200	85	8.18	100791
400	450	275	315	64	250	85	10.2	100792
450	500	441	479	64	250	85	12.78	100793
500	550	452	490	64	250	85	14.94	100794
600	650	474	512	64	250	85	19.5	100795
700	750	496	534	64	250	85	24.9	100796

**Application:**

This item is used to provide a change of direction on a connecting flue pipe on wet positive pressure applications. It is used in combination with a 95 degree tee. The Cap on the middle section may be removed to allow inspection and cleaning access

## Schiedel ICS25

### Inspect. Bend 90° N1

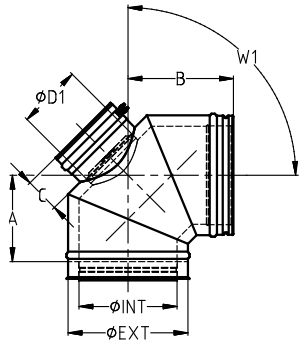

ØINT mm	ØEXT mm	A mm	B mm	C mm	D1 mm	W1 °	Weight kg	Material
80	130	156	200	64	80	90	1.61	101298
100	150	155	199	64	100	90	2.02	101299
130	180	166	210	64	130	90	2.68	100838
150	200	186	230	64	150	90	3.05	100839
180	230	183	227	64	150	90	3.68	100840
200	250	188	232	64	150	90	3.98	100841
230	280	204	248	64	150	90	3.86	100842
250	300	212	256	64	150	90	5.12	100843
300	350	237	281	64	200	90	6.74	100844
350	400	264	308	64	200	90	8.18	100845
400	450	290	330	64	250	90	10.3	100846
450	500	460	498	64	250	90	13.16	100847
500	550	471	509	64	250	90	15.37	100848
600	650	493	531	64	250	90	20.26	100849
700	750	522	560	64	250	90	25.79	100850

#### Application:

This item is used to provide a change of direction on a connecting flue pipe on dry or wet negative pressure applications. The locking plug on the middle section may be removed to allow inspection and cleaning access

# Schiedel ICS25

## Inspect. Bend 90° P1

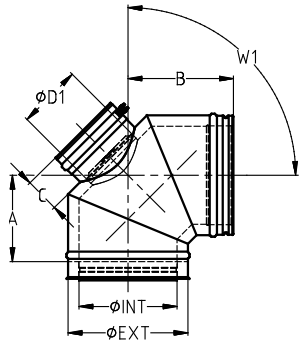

ØINT mm	ØEXT mm	A mm	B mm	C mm	D1 mm	W1 °	Weight kg	Material
80	130	156	200	64	80	90	1.61	100824
100	150	155	199	64	100	90	2.02	100825
130	180	166	210	64	130	90	2.68	100826
150	200	186	230	64	150	90	3.05	100827
180	230	183	227	64	150	90	3.68	100828
200	250	188	232	64	150	90	3.98	100829
230	280	204	248	64	150	90	3.86	101300
250	300	212	256	64	150	90	5.12	100830
300	350	237	281	64	200	90	6.74	100831
350	400	264	308	64	200	90	8.18	100832
400	450	290	330	64	250	90	10.3	100833
450	500	460	498	64	250	90	13.16	100834
500	550	471	509	64	250	90	15.37	100835
600	650	493	531	64	250	90	20.26	100836
700	750	522	560	64	250	90	25.79	100837

### Application:

This item is used to provide a change of direction on a connecting flue pipe on wet positive pressure applications. The locking plug on the middle section may be removed to allow inspection and cleaning access



## Schiedel ICS25

### Insp.bend\_patch 85°

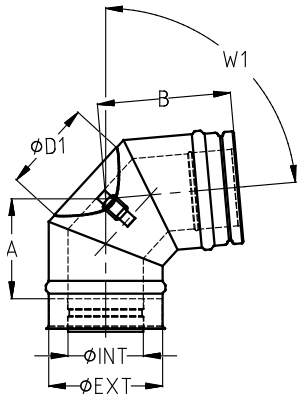

ØINT mm	ØEXT mm	A mm	B mm	D1 mm	W1 °	Weight kg	Material
80	130	126	170	80	85	1.45	112216
100	150	133	177	100	85	1.82	112715
130	180	149	193	110	85	2.41	113311
150	200	158	202	110	85	2.75	114505
180	230	173	217	120	85	3.31	115268
200	250	185	229	120	85	3.58	115863
230	280	199	243	120	85	3.48	116436
250	300	208	252	120	85	4.61	116849
300	350	232	276	120	85	6.07	117566
350	400	258	302	120	85	7.36	118131

#### Application:

This item is used to provide a change of direction on a connecting flue pipe on dry or wet negative pressure applications. The cover plate on the middle section may be removed to allow inspection and cleaning access

# Schiedel ICS25

## Insp. Bend Patch

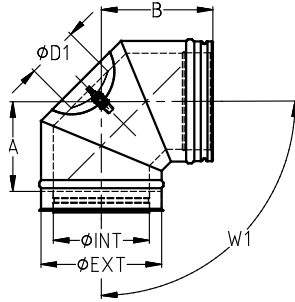

ØINT mm	ØEXT mm	A mm	B mm	D1 mm	W1 °	Weight kg	Material
80	130	128	172	80	90	1.45	112217
100	150	136	180	100	90	1.82	109584
100	150	136	180	100	90	1.82	148409
130	180	152	196	110	90	2.41	109585
150	200	161	205	110	90	2.75	109586
180	230	176	220	120	90	3.31	109587
200	250	188	232	120	90	3.58	109588
230	280	204	248	120	90	3.48	116425
250	300	212	256	120	90	4.61	109589
300	350	237	281	120	90	6.07	117563
350	400	264	308	120	90	7.36	118133
400	450	290	330	150	90	9.9	118550
450	500	396	434	150	90	11.61	113822
500	550	421	459	150	90	13.6	119136
600	650	471	509	150	90	18	115483
700	750	522	560	150	90	22.98	115592

### Application:

This item is used to provide a change of direction on a connecting flue pipe on dry or wet negative pressure applications. The cover plate on the middle section may be removed to allow inspection and cleaning access

# Schiedel ICS25

## Top plate

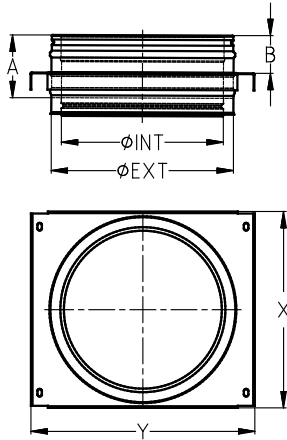

ØINT mm	ØEXT mm	A mm	B mm	X mm	Y mm	Nominal length mm	Weight kg	Material
80	130	155	95	188	256	200	1.65	101070
100	150	155	95	208	276	200	2.07	101071
130	180	155	95	238	306	200	2.69	101072
150	200	155	95	258	326	200	3.11	101073
180	230	155	95	278	356	200	3.73	101074
200	250	155	95	285	353	200	4.15	101075
230	280	155	95	315	383	200	4.77	101341
250	300	155	95	335	403	200	5.19	101076
300	350	155	95	385	453	200	6.22	101077
350	400	155	95	435	503	200	7.26	101078
400	450	155	95	485	553	200	8.07	101079
450	500	155	95	535	603	200	9.08	101080
500	550	155	95	585	653	200	10.09	101081
600	650	155	95	685	753	200	12.1	101082
700	750	155	95	785	853	200	14.12	101083

### Application:

This item may be used as the Top Plate on a Base or Intermediate Wall Support on a wall mounted Vertical Chimney in combination with a Pair of Side Plates or Cantilever brackets (see below). It can also be used as a top plate in combination with a Telecopic Floor Support. (See Load bearing Section)

## Schiedel ICS25

### ICS\_ZERO

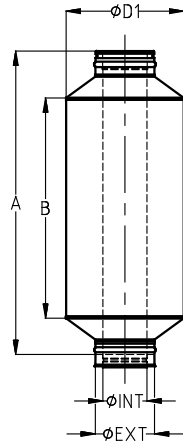

ØINT mm	ØEXT mm	A mm	B mm	D1 mm	Nominal length mm	Weight kg	Material
80	130	1282	1000	330	1327	21.35	142961
100	150	1282	1000	350	1327	23.22	142962
130	180	1282	1000	380	1327	26.14	142963
150	200	1032	750	400	1077	22.77	142964
180	230	1032	750	430	1077	25.12	142965
200	250	1032	750	450	1077	26.7	142966
250	300	1032	750	500	1077	30.62	142967
300	350	1032	750	550	1077	34.63	142968

### Ignis Protect

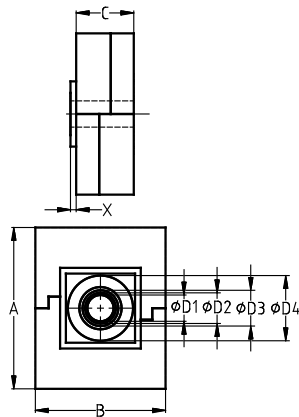

A mm	B mm	C mm	D1 mm	D2 mm	D3 mm	D4 mm	X mm	Weight kg	Material
700	565	100	114	133	155	283	25	4	101840
700	565	150	114	133	155	283	25	6	101841
700	565	200	114	133	155	283	25	8.4	101842
700	565	250	114	133	155	283	25	10.5	101843
700	565	300	114	133	155	283	25	12.5	101844
700	565	350	114	133	155	283	25	15	101845
700	565	400	114	133	155	283	25	16.7	101846

## Schiedel ICS25

### Base support with anchor plate

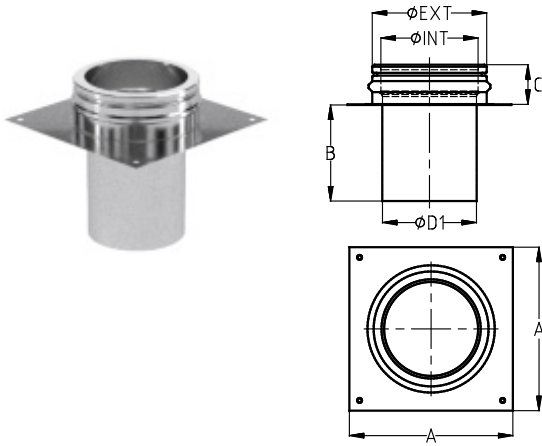

ØINT mm	ØEXT mm	A mm	B mm	C mm	D1 mm	Weight kg	Material
80	130	250	235	97	78	2.36	104394
100	150	270	235	97	98	2.77	101001
80	130	250	235	97	78	2.36	148380
100	150	270	235	97	98	2.77	148381
130	180	300	235	97	128	3.38	101002
150	200	320	235	97	148	3.79	101003
180	230	350	235	97	178	4.4	101004
200	250	370	235	97	198	4.82	101005
230	280	400	235	97	228	5.46	101336
250	300	420	235	97	248	5.87	101006
300	350	475	235	97	298	6.97	101007
350	400	525	235	97	348	8.07	101008
400	450	575	235	97	397.5	9.11	101009
450	500	625	235	97	447.5	9.12	101010
500	550	675	235	97	497.5	10.46	101011
600	650	775	235	97	597.4	13.39	101012
700	750	875	235	97	697.4	16.64	101013

#### Application:

The extension support is used to extend an existing traditional brick or block chimney, where a higher chimney is required in order to meet termination guidelines. The base is secured to the existing chimney and then sections of standard ICS can be built up to the required termination height.

# Schiedel ICS25

## Adaptor with anchor plate UNI

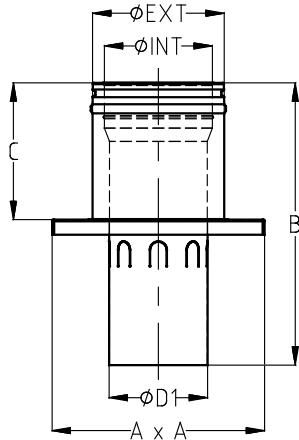

ØINT mm	ØEXT mm	A mm	B mm	C mm	D1 mm	Nominal length mm	Weight kg	Material
130	180	333	495	240	115	495	4.02	116593
150	200	333	495	240	135	495	4.23	116765
180	230	333	495	240	153	495	4.51	116958
180	230	373	495	240	173	495	5.05	117308
200	250	373	495	240	193	495	5.24	117369
250	300	493	495	240	240	495	7.54	118205
300	350	563	495	240	285	495	9.18	118646
350	400	613	495	240	335	495	10.5	120543

**Application:**

The extension support is used to extend an existing UNI (SIH) system, where a higher chimney is required in order to meet termination guidelines. The base is secured to the existing chimney and then sections of standard ICS can be built up to the required termination height.

## Adaptor with anchor plate ABS

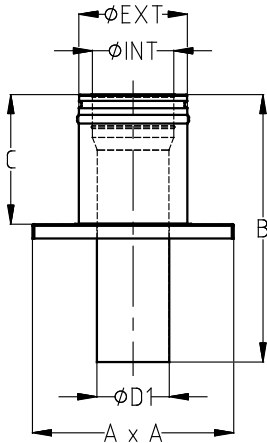

ØINT mm	ØEXT mm	A mm	B mm	C mm	D1 mm	Nominal length mm	Weight kg	Material
130	180	373	495	240	115	495	4.4	116884
150	200	373	495	240	135	495	4.67	117058
180	230	373	495	240	153	495	5.01	117276
180	230	373	495	240	173	495	5.12	117346
200	250	383	495	240	193	495	5.4	117412

**Application:**

The extension support is used to extend an existing Absolut system, where a higher chimney is required in order to meet termination guidelines. The base is secured to the existing chimney and then sections of standard ICS can be built up to the required termination height.

# Schiedel ICS25

## Chimney tops

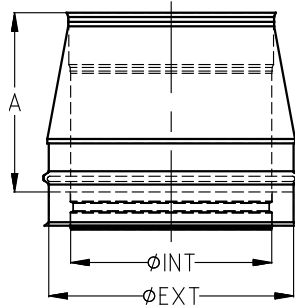

ØINT mm	ØEXT mm	A mm	Nominal length mm	Weight kg	Material
80	130	205	250	0.88	101212
100	150	205	250	1.05	101213
80	130	205	250	0.88	120565
100	150	205	250	1.05	148392
130	180	205	250	1.31	101214
150	200	205	250	1.48	101215
180	230	205	250	1.74	101216
200	250	205	250	1.91	101217
230	280	205	250	2.17	101369
230	280	205	250	2.17	114420
250	300	205	250	2.34	101218
250	300	205	250	2.34	114704
300	350	205	250	2.76	101219
300	350	205	250	2.76	115212
350	400	205	250	3.2	101220
350	400	205	250	3.2	115841
400	450	205	250	3.63	101221
450	500	205	250	3.93	101222
450	500	205	250	3.93	116479
500	550	205	250	4.34	101223
600	650	205	250	5.16	101224
600	650	205	250	5.16	117352
700	750	205	250	5.98	101225

**Application:**

This item is used to terminate an installation and allows for a minimum resistance to the flue gases exiting from the chimney. Please refer to your own national building regulations with regard to termination heights above roof level and with respect to fuel types allowed. This item makes possible to termination of chimney by the Raincap from PRIMA PLUS.

## Schiedel ICS25

### AS Terminal

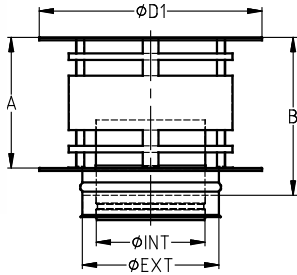

ØINT mm	ØEXT mm	A mm	B mm	D1 mm	D3 mm	Weight kg	Material
130	180	130	180	250	201.3	1.6	114352
150	200	175	225	300	230	2.02	114830
180	230	200	250	350	280	2.57	115893
200	250	240	290	400	300	3.15	116496
230	280	250	300	450	350	3.83	117167
250	300	297	347	500	400	4.58	117700
300	350	346	396	600	450	6.11	118432
350	400	384	434	700	500	7.84	118461
400	450	439	489	800	600	8.32	118556

#### Application:

This item is used to terminate an installation and provides extra protection to avoid rainwater from entering the chimney system, whilst minimising problems associated with downdraught. Please refer to your own national building regulations with regard to termination heights above roof level and with respect to fuel types allowed.

### AS Terminal with mesh

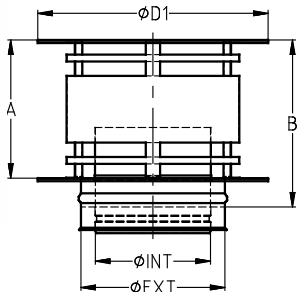

ØINT mm	ØEXT mm	A mm	B mm	D1 mm	D3 mm	Weight kg	Material
130	180	130	180	250	180	1.62	114904
150	200	175	225	300	230	2.04	115166
180	230	200	250	350	280	2.6	116258
200	250	240	290	400	300	3.18	116970
230	280	250	300	450	350	3.87	117466
250	300	297	347	500	400	4.63	118025
300	350	346	396	600	450	6.17	118645
350	400	384	434	700	500	7.92	118722
400	450	440	485	809	600	8.4	113597

#### Application:

This item is used to terminate an installation and provides extra protection to avoid rainwater from entering the chimney system, whilst minimising problems associated with downdraught. Please refer to your own national building regulations with regard to termination heights above roof level and with respect to fuel types allowed. The mesh on this terminal acts as an anti-spark guard for use on thatched roofs. Care should be taken to ensure that the chimney is cleaned regularly and that soot does not build up on the mesh restricting the path of the flue gases.



## Schiedel ICS25

### As Terminal. Insp.

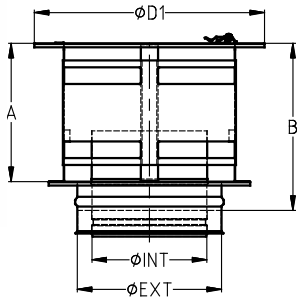

ØINT mm	ØEXT mm	A mm	B mm	D1 mm	Weight kg	Material
130	180	130	180	250	1.6	119017
150	200	175	225	300	2.02	119016
180	230	200	250	350	2.57	119015
200	250	240	290	400	3.15	119014
230	280	250	300	450	3.83	119013
250	300	297	347	500	4.58	119012
300	350	346	396	600	6.11	119011
350	400	384	434	700	7.84	119010

#### Application:

This item is used to terminate an installation and provides extra protection to avoid rainwater from entering the chimney system, whilst minimising problems associated with downdraught. Please refer to your own national building regulations with regard to termination heights above roof level and with respect to fuel types allowed. Speciality is the upper cover is opening without removal entire terminal. It facilitates of inspection and cleaning of chimney.

### Raincap

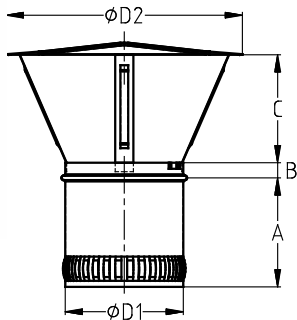

ØINT mm	ØEXT mm	A mm	B mm	C mm	D1 mm	D2 mm	Weight kg	Material
80	130	180	25	100	75	160	0.37	133783
100	150	180	25	100	95	200	0.49	133784
130	180	180	25	140	125	240	0.66	133787
150	200	180	25	140	145	280	0.72	133789
180	230	180	25	180	175	330	1.05	133791
200	250	180	25	180	195	380	1.27	133792
230	280	180	25	250	224	410	1.5	133793
250	300	180	25	250	244	430	1.61	133794
300	350	180	25	250	294	430	1.96	133795

## Schiedel ICS25

### Raincap\_Meidinger

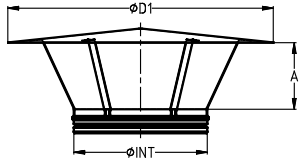

ØINT mm	A mm	D1 mm	Weight kg	Material
350	235	800	2.16	114414
350	235	800	2.16	112074
400	261	900	4.92	100939
450	288	995	6.11	100940
450	288	995	6.11	129582
500	285	995	7.37	100941
600	283	995	7.57	100942
700	278	995	7.71	100943

# Schiedel ICS25

## Chimney Tops Raincap

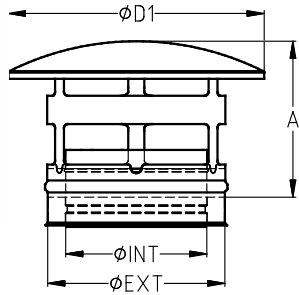
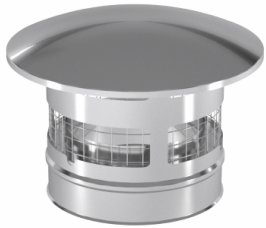

ØINT mm	ØEXT mm	A mm	D1 mm	Weight kg	Material
80	130	210	266	1.37	112505
100	150	213	266	1.54	112800
80	130	210	266	1.37	112499
100	150	213	266	1.54	112795
130	180	219	266	1.79	113183
150	200	213	362	2.3	114575
180	230	217	362	2.59	115005
200	250	220	362	2.79	115242
230	280	225	362	3.09	115729
250	300	229	362	3.28	115942
300	350	251	490	4.25	116792
350	400	257	570	5.15	117350
400	450	262	660	5.72	117545
450	500	268	740	6.31	117870

**Application:**

This item is used to terminate an installation and helps prevent rainwater from entering the chimney system. Please refer to your own national building regulations with regard to termination heights above roof level and with respect to fuel types allowed. It is advised to use the raincap without mesh on solid fuel applications in order to avoid soot build up restricting the airway.

## Schiedel ICS25

### Raincap with mesh

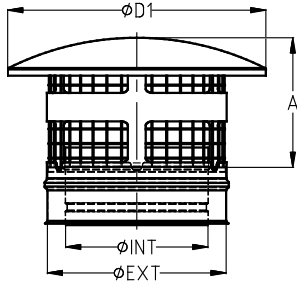

$\phi INT$ mm	$\phi EXT$ mm	A mm	B mm	D1 mm	Weight kg	Material
80	130	210	181	266	1.51	112768
100	150	213	181	266	1.7	113114
80	130	210	181	266	1.51	122769
100	150	213	181	266	1.7	113085
130	180	219	219	266	1.97	113534
150	200	213	213	362	2.53	114970
180	230	217	217	362	2.85	115364
200	250	220	220	362	3.06	115702
230	280	225	225	362	3.4	116037
250	300	229	229	362	3.61	116222
300	350	251	251	490	4.68	117060
350	400	257	257	570	5.67	117533
400	450	262	262	660	6.29	117858
450	500	268	268	740	6.94	118066

#### Application:

This item is used to terminate an installation and helps prevent rainwater from entering the chimney system. Please refer to your own national building regulations with regard to termination heights above roof level and with respect to fuel types allowed. The mesh helps to prevent birds from entering the chimney and nesting. It is advised to use the raincap without mesh on solid fuel applications in order to avoid soot build up restricting the airway.