

Detail:
adjustable
ball point

Horizontal Clamp Unit

with ball point $\varnothing 10$

| Nr. | A | B | C | D | |
|-------|-----|----|----|----|-----|
| 91655 | 105 | 50 | 25 | 10 | 156 |
| 91869 | 194 | 50 | 25 | 10 | 327 |

Horizontal Clamp Unit

with adjustable ball point $\varnothing 10$

| Nr. | A | B | C | D | |
|-------|-----|----|----|----|-----|
| 93520 | 105 | 50 | 25 | 10 | 143 |
| 93521 | 194 | 50 | 25 | 10 | 762 |

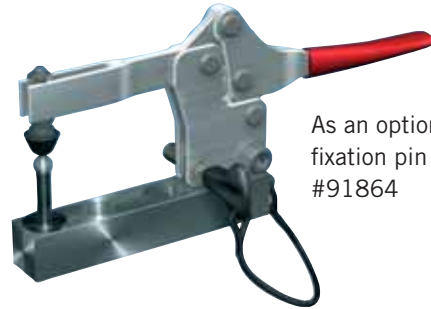

As an option
fixation pin
#91864

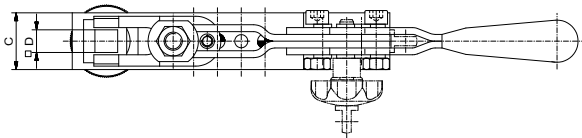
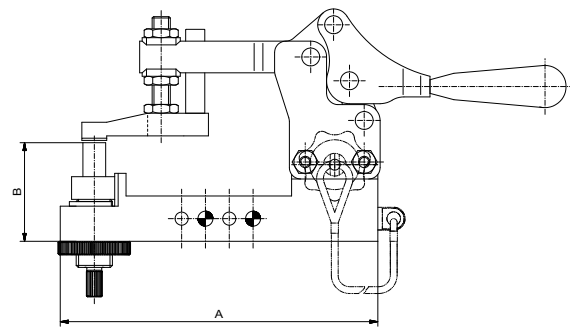

As an option
fixation pin
#91864

Horizontal Clamp Unit

height adjustable

| Nr. | A | B | C | D | |
|-------|-----|------|----|----|-----|
| 93519 | 140 | 43,5 | 25 | 10 | 156 |

- Support surface 10x10mm secured against rotation and exchangeable
- With pressure fork
- 6mm shift
- Can support Meisterbock screws

